

MADISON SCHOOL DISTRICT  
BOARD OF EDUCATION  
REGULAR MEETING  
MARCH 18, 2019  
**6:00 PM – Board Room**

**\*\* TABLE OF CONTENTS \*\***

- 1 REGULAR MEETING AGENDA
- 2 MINUTES FROM THE FEBRUARY 25, 2019 BOARD MEETING
- 3 MONTHLY BILLS
- 4 SUPERINTENDENT'S REPORT
- 5 HIGH SCHOOL PRINCIPAL'S REPORT
- 6 MIDDLE SCHOOL PRINCIPAL'S REPORT
- 7 ELEMENTARY SCHOOL PRINCIPAL'S REPORT
- 8 FOOD SERVICE DIRECTOR'S REPORT
9. ATHLETIC DIRECTOR REPORT

MADISON SCHOOL DISTRICT  
BOARD OF EDUCATION  
REGULAR MEETING  
MARCH 18, 2019  
**6:00 PM – Board Room**

**\*\* AGENDA \*\***

- 1) CONSENT AGENDA
  - A. APPROVAL OF MINUTES
  - B. ACCEPTANCE OF REPORTS
  - C. APPROVAL OF BILLS/REIMBURSEMENT OF EXPENSES
- 2) WINTER ATHLETICS
- 3) CORDS ACROSS AMERICA
- 4) AMENDMENT – HEALTH PLAN A AND HEALTH PLAN B PURCHASING CONSORTIUM AGREEMENTS



Resolved this 25 day of February, 2019.

Roll Call Vote: Passed: 6 Failed: 0

---

Board Representative Name

Board Representative Signature

A motion was made by Mark Swinehart, and supported by Natasha Manchester, that the Board move to closed session at 6:32 p.m. for a student disciplinary hearing.

Ayes 6

Nays 0

Motion Carried

A motion was made by Mark Swinehart, and supported by Natasha Manchester, that the Board move to open session at 6:51 p.m.

### **BOARD RESOLUTION FOR STUDENT DISCIPLINE**

The following preamble and resolution were offered by Member Julie Ramos and supported by Member Natasha Manchester.

#### **WHEREAS:**

1. The administration has recommended that a student whose identity is known to the Board (the "Student") be suspended for possessing prescription medication while at school which did not belong to the Student and providing the prescription medication to another student.

2. School administrators notified the Student's parents of the specific charge underlying the discipline recommendation, as well as the date, time, and place of the disciplinary hearing.

3. Pursuant to the request of the Student's parents, and as authorized by Section 8(b) of the Michigan Open Meetings Act, MCL 15.268(b), the disciplinary hearing was conducted in a closed session meeting of the Board.

4. The hearing afforded the Student and the Student's representatives an opportunity to respond to the charge and to present pertinent evidence for the Board's consideration.

5. The Board has carefully considered all of the evidence produced in this student discipline hearing.

#### **NOW, THEREFORE, BE IT RESOLVED THAT:**

1. A preponderance of the evidence establishes that on January 18, 2019, the Student possessed prescription medication while at school which did not belong to the Student and provided the prescription medication to another student in violation of the following sections of the Madison Middle School Student and Parent Handbook: Drugs & Alcohol, page 19, and Madison School District Board Policy: Drug Prevention, Board Policy 5530.

2. Based on careful consideration of all of the following factors, the Board determines that expulsion is not warranted, but that suspension is:

- The student's age;
- The student's disciplinary history;
- Whether the student has a disability;
- The seriousness of the behavior;

- Whether the behavior posed a safety risk;
- Whether restorative practices are a better option; and
- Whether lesser interventions would address the behavior.

3. The Student is suspended for the remainder of the 2018-2019 school year and is eligible to return to school at the beginning of the 2019-2020 school year.

4. During the time of the suspension, the Student may not be on school grounds or attend any functions at the District without prior written approval from the Superintendent.

5. Consistent with Sections 11a and 1311(1) of the Revised School Code, the Board finds that the interests of the District are served by this resolution.

6. Administrators are directed and authorized to implement all terms of this resolution and are delegated all necessary authority to do so.

7. All resolutions and parts of resolutions that conflict with the provisions of this resolution are rescinded.

Ayes: Julie Ramos, Ruben Villegas, Natasha Manchester, Mark Swinehart, Eric McDonald, Tina Claiborne

Nays:

Absent: Greg Choinski

Motion Passed: 6-0

The undersigned, duly qualified and acting Board Secretary, certifies that the foregoing constitutes a true and complete copy of a resolution adopted by said Board at a regular meeting held on February 25, 2019, the original of which is part of the Board's minutes. The undersigned further certifies that notice of the meeting was given to the public pursuant to the provisions of the "Open Meetings Act" (Act 267, PA 1976, as amended).

---

Mark Swinehart, Board Secretary

A motion was made by Ruben Villegas, and supported by Tina Claiborne, that the Board move to closed session at 6:53 p.m. to discuss Negotiations with Madison EA.

Ayes 6

Nays 0

Motion Carried

A motion was made by Julie Ramos, and supported by Mark Swinehart, that the Board move to open session at 8:40 p.m.

The next regularly scheduled Board meeting is March 18, 2019.

A motion to adjourn the meeting at 8:05 p.m. was made by Tina Claiborne, and supported by Eric McDonald.

Ayes 6

Nays 0

Motion Carried

Respectfully submitted,

---

Secretary, Board of Education

SPI  
 DATE: 03/15/2019  
 TIME: 11:55:07

MADISON SCHOOL DISTRICT  
 DETAIL REVENUE STATUS REPORT

PAGE NUMBER: 1  
 REVSTA31

SELECTION CRITERIA: orgn.fund='11'  
 ACCOUNTING PERIOD: 8/19

SORTED BY: FUND,DEPARTMENT,FUNCTION,ACCOUNT  
 TOTALED ON: FUND,DEPARTMENT  
 PAGE BREAKS ON: FUND

ORGANIZATION / ACCOUNT / TITLE	BUDGET	PERIOD RECEIPTS	RECEIVABLES	YEAR TO DATE REVENUE	BALANCE
11-0111-000-0000-00000-0001 0111 CURR TAX ADRIAN CIT	730,283.35	333,133.51	.00	797,581.17	-67,297.82
11-0111-000-0000-00000-0001 0112 CURR TAX MADISON TW	1,097,220.79	460,555.15	.00	1,168,798.27	-71,577.48
11-0111-000-0000-00000-0001 0113 CURR TAX PALMYRA TW	60,000.04	5,662.29	.00	54,517.52	5,482.52
11-0111-000-0000-00000-0001 0114 CURR TAX ADRIAN TWP	19,602.25	8,330.79	.00	16,664.32	2,937.93
11-0111-000-0000-00000-0001 0116 CURR TAX OTHER TAXE	.00	.00	.00	.00	.00
TOTAL DEPARTMENT - CURRENT TAX REVENUE	1,907,106.43	807,681.74	.00	2,037,561.28	-130,454.85
11-0119-000-0000-00000-0002 0119 INT ON DELINQUENT T	36,925.00	156.94	.00	3,611.24	33,313.76
11-0131-000-0000-00000-0002 0131 TUITION PARENT PAY	21,000.00	164.22	.00	5,797.22	15,202.78
11-0151-000-0000-00000-0002 0151 INTEREST ON INVESTM	35,000.00	5,062.21	.00	37,302.93	-2,302.93
11-0171-000-0000-00000-0002 0171 ADMISSIONS ADMISSIO	96,000.00	.00	.00	.00	96,000.00
11-0173-000-0000-00000-0002 0173 EXTRA TRIP SURCHARG	858.00	.00	.00	200.00	658.00
11-0181-000-0000-00000-0002 0181 LATCH KEY PARENT PA	83,400.00	6,890.00	.00	44,529.00	38,871.00
11-0191-000-0000-00000-0002 0191 RENTAL SCHOOL RENTA	7,392.00	500.00	.00	1,100.00	6,292.00
11-0192-000-0000-00000-0002 0192 DONATIONS DONATIONS	.00	.00	.00	.00	.00
11-0199-000-0000-00000-0002 0195 MISC MISC CAFE	.00	.00	.00	.00	.00
11-0199-000-0000-00000-0002 0199 MISC MISC	10,168.00	8,289.00	.00	106,763.17	-96,595.17
TOTAL DEPARTMENT - OTHER LOCAL REVENUE	290,743.00	21,062.37	.00	199,303.56	91,439.44
11-0311-000-0000-00000-0003 0010 STATE AID MEMBERSHI	10,987,937.00	1,005,448.59	.00	5,034,717.85	5,953,219.15
11-0311-000-0000-00000-0003 0207 STATE AID MEMBERSHI	.00	.00	.00	.00	.00
11-0311-000-0000-00000-0003 0208 STATE AID MEMBERSHI	193,817.00	.00	.00	.00	193,817.00
11-0312-000-0000-00000-0003 0020 RESTRICTED STATE AT	634,299.00	62,558.64	.00	312,594.50	321,704.50
11-0312-000-0000-00000-0003 0100 RESTRICTED STATE ST	.00	.00	.00	.00	.00
11-0312-000-0000-00000-0003 0110 RESTRICTED STATE LU	.00	2,639.90	.00	13,199.48	-13,199.48
11-0312-000-0000-00000-0003 0120 RESTRICTED STATE SP	450,524.00	84,327.08	.00	241,163.09	209,360.91
11-0312-000-0000-00000-0003 0160 RESTRICTED STATE CA	.00	1,362.27	.00	6,811.37	-6,811.37
11-0312-000-0000-00000-0003 0208 RESTRICTED STATE UA	1,298,199.00	138,053.07	.00	659,678.19	638,520.81
11-0312-000-0000-00000-0003 0210 RESTRICTED STATE TE	.00	.00	.00	.00	.00
11-0312-000-0000-00000-0003 0211 RESTRICTED STATE UN	.00	.00	.00	.00	.00
11-0312-000-0000-00000-0003 0223 RESTRICTED STATE CT	.00	634.03	.00	3,170.14	-3,170.14
11-0312-000-0000-00000-0003 0313 RESTRICTED STATE ST	.00	.00	.00	.00	.00
11-0312-000-0000-00000-0003 0358 RESTRICTED STATE FI	.00	.00	.00	1,613.52	-1,613.52
11-0312-000-0000-00000-0003 0359 RESTRICTED STATE CO	.00	775.80	.00	3,878.97	-3,878.97
11-0312-000-0000-00000-0003 0367 RESTRICTED STATE EA	.00	2,386.47	.00	15,912.12	-15,912.12
11-0312-000-0000-00000-0003 0370 RESTRICTED STATE HE	.00	3,819.31	.00	15,148.73	-15,148.73
11-0317-000-0000-00000-0003 0210 REST ANOTHER SCHOOL	.00	.00	.00	.00	.00
TOTAL DEPARTMENT - STATE REVENUE CATEGORICA	13,564,776.00	1,302,005.16	.00	6,307,887.96	7,256,888.04
11-0412-000-0000-00000-0004 0240 STAB ARRA EDU JOBS	.00	.00	.00	.00	.00
11-0414-000-0000-00000-0004 0140 SPS REV TITLE I	265,779.00	.00	.00	.00	265,779.00
11-0414-000-0000-00000-0004 0141 SPS REV TITLE I CAR	.00	.00	.00	.00	.00
11-0414-000-0000-00000-0004 0150 SPS REV TITLE VA IN	.00	.00	.00	.00	.00
11-0414-000-0000-00000-0004 0210 SPS REV TECHNOLOGY	.00	.00	.00	.00	.00
11-0414-000-0000-00000-0004 0490 SPS REV TITLE II D	.00	.00	.00	.00	.00
11-0414-000-0000-00000-0004 0753 SPS REV TITLE IV SS	17,961.00	.00	.00	.00	17,961.00
11-0414-000-0000-00000-0004 0764 SPS REV II TEACHER	40,633.00	.00	.00	.00	40,633.00
11-0414-000-0000-00000-0004 0768 SPS REV RURAL	.00	.00	.00	.00	.00
11-0417-000-0000-00000-0004 0060 RESTR REV DRUG FREE	.00	.00	.00	.00	.00

SPI  
 DATE: 03/15/2019  
 TIME: 11:55:07

MADISON SCHOOL DISTRICT  
 DETAIL REVENUE STATUS REPORT

PAGE NUMBER: 2  
 REVSTA31

SELECTION CRITERIA: orgn.fund='11'  
 ACCOUNTING PERIOD: 8/19

SORTED BY: FUND,DEPARTMENT,FUNCTION,ACCOUNT  
 TOTALED ON: FUND,DEPARTMENT  
 PAGE BREAKS ON: FUND

ORGANIZATION / ACCOUNT / TITLE	BUDGET	PERIOD RECEIPTS	RECEIVABLES	YEAR TO DATE REVENUE	BALANCE
11-0417-000-0000-00000-0004 0160 RESTR REV CAREER &	.00	.00	.00	.00	.00
11-0417-000-0000-00000-0004 0199 RESTR REV MISC	.00	.00	.00	.00	.00
11-0417-000-0000-00000-0004 0211 RESTR REV UNREST AN	.00	.00	.00	.00	.00
11-0417-000-0000-00000-0004 0220 RESTR REV PARENT ED	.00	.00	.00	.00	.00
11-0417-000-0000-00000-0004 0416 RESTR REV MEDICAID	2,600.00	.00	.00	3,467.27	-867.27
11-0419-000-0000-00000-0004 0419 MISC - FED SPEC ED	.00	.00	.00	.00	.00
TOTAL DEPARTMENT - FEDERAL REVENUE	326,973.00	.00	.00	3,467.27	323,505.73
11-0511-000-0000-00000-0005 0511 SPEC ED TUITION	55,426.00	.00	.00	.00	55,426.00
11-0519-000-0000-00000-0005 0122 LISD SPEC ED LISD S	680,000.00	.00	.00	562,871.45	117,128.55
11-0519-000-0000-00000-0005 0196 LISD SPEC ED INNOVA	23,000.00	16,206.00	.00	16,206.00	6,794.00
11-0519-000-0000-00000-0005 0197 LISD SPEC ED PLTW	84,500.00	.00	.00	14,375.60	70,124.40
11-0519-000-0000-00000-0005 0198 LISD SPEC ED CAREER	9,400.00	.00	.00	.00	9,400.00
11-0519-000-0000-00000-0005 0199 LISD SPEC ED MISC	63,843.00	22,100.17	.00	29,473.31	34,369.69
11-0519-000-0000-00000-0005 0220 LISD SPEC ED PARENT	9,600.00	.00	.00	1,327.68	8,272.32
11-0519-000-0000-00000-0005 0303 LISD SPEC ED CAREER	.00	.00	.00	.00	.00
11-0519-000-0000-00000-0005 0340 LISD SPEC ED MICHIG	245,000.00	.00	.00	.00	245,000.00
11-0519-000-0000-00000-0005 0416 LISD SPEC ED MEDICA	.00	.00	.00	.00	.00
11-0541-000-0000-00000-0005 0541 INSURANCE DIVIDENDS	14,000.00	.00	.00	5,217.67	8,782.33
11-0552-000-0000-00000-0005 0552 ADJ TO PRIOR YRS AC	.00	.00	.00	.00	.00
11-0593-000-0000-00000-0005 0593 SALE SCHOOL PROPERT	.00	.00	.00	.00	.00
11-0625-000-0000-00000-0005 0625 FUND MOD CAFE FUND	24,000.00	.00	.00	.00	24,000.00
TOTAL DEPARTMENT - INCOMING TRANSFERS	1,208,769.00	38,306.17	.00	629,471.71	579,297.29
TOTAL FUND - GENERAL FUND	17,298,367.43	2,169,055.44	.00	9,177,691.78	8,120,675.65
TOTAL REPORT	17,298,367.43	2,169,055.44	.00	9,177,691.78	8,120,675.65

SPI  
 DATE: 03/15/2019  
 TIME: 12:03:09

MADISON SCHOOL DISTRICT  
 DETAIL EXPENDITURE STATUS REPORT

PAGE NUMBER: 1  
 EXPSTA11

SELECTION CRITERIA: orgn.fund='11'  
 ACCOUNTING PERIOD: 8/19

SORTED BY: FUND,DEPARTMENT,FUNCTION,ACCOUNT  
 TOTALED ON: FUND,DEPARTMENT  
 PAGE BREAKS ON: FUND

FUND - 11 - GENERAL FUND

ORGANIZATION / ACCOUNT / TITLE	BUDGET	PERIOD EXPENDITURES	ENCUMBRANCES OUTSTANDING	YEAR TO DATE EXP	AVAILABLE BALANCE
11-2134-000-0000-00000-0000 2130 CAFETERIA EMPLOYEE	.00	49.20	.00	196.55	-196.55
11-2134-000-0000-00000-0000 2820 CAFETERIA EMPLOYEE	.00	.00	.00	.00	.00
11-2134-000-0000-00000-0000 2830 CAFETERIA EMPLOYER	.00	.00	.00	.00	.00
TOTAL DEPARTMENT - INTERFUND	.00	49.20	.00	196.55	-196.55
11-1118-000-0340-02315-0010 1226 EL.PRE SUPERVISION	9,203.60	715.66	.00	6,083.11	3,120.49
11-1118-000-0340-02315-0010 1240 EL.PRE SALARY TEACH	113,980.00	9,782.10	.00	63,583.65	50,396.35
11-1118-000-0340-02315-0010 1630 EL.PRE SALARY AIDE	49,481.24	4,617.60	.00	30,190.08	19,291.16
11-1118-000-0340-02315-0010 1639 EL.PRE TRANS AIDE	.00	.00	.00	.00	.00
11-1118-000-0340-02315-0010 1870 EL.PRE SALARY-SUBST	.00	.00	.00	.00	.00
11-1118-000-0340-02315-0010 2130 EL.PRE EMPLOYEE INS	29,982.30	2,599.67	.00	18,571.24	11,411.06
11-1118-000-0340-02315-0010 2820 EL.PRE EMPLOYEE RET	47,771.02	3,801.50	.00	25,903.57	21,867.45
11-1118-000-0340-02315-0010 2821 EL.PRE RETIREMT STU	27,262.18	2,283.47	.00	11,417.34	15,844.84
11-1118-000-0340-02315-0010 2830 EL.PRE EMPLOYER SOC	14,313.02	1,104.24	.00	7,226.49	7,086.53
11-1118-000-0340-02315-0010 2840 EL.PRE WORKMANS COM	86.00	.00	.00	86.00	.00
11-1118-000-0340-02315-0010 2920 EL.PRE CASH IN LIEU	984.15	50.46	.00	428.91	555.24
11-1118-000-0340-02315-0010 2990 EL.PRE SICK DAY REI	1,113.00	.00	.00	.00	1,113.00
11-1118-000-0340-02315-0010 3110 EL.PRE PURCHASED SE	300.00	.00	.00	.00	300.00
11-1118-000-0340-02315-0010 3210 EL.PRE MILEAGE REIM	.00	.00	.00	.00	.00
11-1118-000-0340-02315-0010 3220 EL.PRE WKSHOPS/CONF	250.00	.00	.00	660.00	-410.00
11-1118-000-0340-02315-0010 4120 EL.PRE REPAIRS EQUI	.00	.00	.00	.00	.00
11-1118-000-0340-02315-0010 5110 EL.PRE TEACHING SUP	800.00	.00	.00	867.22	-67.22
11-1118-000-0340-02315-0010 5140 EL.PRE TRANSPORTATI	.00	.00	.00	.00	.00
11-1118-000-0340-02315-0010 5990 EL.PRE MISC. SUPPLI	300.00	.00	.00	.00	300.00
11-1118-000-0340-02315-0010 6410 EL.PRE NEW EQUIP/FU	.00	.00	.00	.00	.00
11-1118-000-0340-02315-0010 7410 EL.PRE DUES/FEES	100.00	63.00	.00	1,284.75	-1,184.75
11-1213-000-0340-02315-0010 3130 EL.NURSE NURSING	.00	.00	.00	.00	.00
11-1216-000-0340-02315-0010 1440 EL.SOCWRK SALARY PS	3,508.90	266.06	.00	1,729.38	1,779.52
11-1216-000-0340-02315-0010 2820 EL.SOCWRK EMPLOYEE	.00	69.66	.00	451.14	-451.14
11-1216-000-0340-02315-0010 2830 EL.SOCWRK EMPLOYER	.00	21.16	.00	135.96	-135.96
11-1216-000-0340-02315-0010 2920 EL.SOCWRK CASH IN L	.00	25.24	.00	164.05	-164.05
11-1271-000-0340-02315-0010 1610 EL.TRANS SALARY VEH	8,084.48	.00	.00	.00	8,084.48
11-1271-000-0340-02315-0010 2820 EL.TRANS EMPLOYEE R	.00	.00	.00	.00	.00
11-1271-000-0340-02315-0010 2830 EL.TRANS EMPLOYER S	.00	.00	.00	.00	.00
TOTAL DEPARTMENT - PRE-SCHOOL INSTRUCTION	307,519.89	25,399.82	.00	168,782.89	138,737.00
11-1111-000-0000-02315-0011 1240 EL.REG SALARY TEACH	2,676,798.58	202,437.94	.00	1,318,943.41	1,357,855.17
11-1111-000-0000-02315-0011 1242 EL.REG ISSI	.00	67.86	.00	67.86	-67.86
11-1111-000-0000-02315-0011 1250 EL.REG INSTR SPECIA	.00	.00	.00	.00	.00
11-1111-000-0000-02315-0011 1450 EL.REG SCHOOL NURSE	.00	.00	.00	9,784.09	-9,784.09
11-1111-000-0000-02315-0011 1630 EL.REG SALARY AIDE	19,000.00	265.00	.00	1,060.00	17,940.00
11-1111-000-0000-02315-0011 1870 EL.REG SALARY-SUBST	3,598.10	57.25	.00	4,151.73	-553.63
11-1111-000-0000-02315-0011 2130 EL.REG EMPLOYEE INS	473,737.14	40,789.78	.00	289,495.12	184,242.02
11-1111-000-0000-02315-0011 2210 EL.REG EARLY RETIRE	.00	.00	.00	.00	.00



SPI  
 DATE: 03/15/2019  
 TIME: 12:03:09

MADISON SCHOOL DISTRICT  
 DETAIL EXPENDITURE STATUS REPORT

PAGE NUMBER: 2  
 EXPSTA11

SELECTION CRITERIA: orgn.fund='11'  
 ACCOUNTING PERIOD: 8/19

SORTED BY: FUND,DEPARTMENT,FUNCTION,ACCOUNT  
 TOTALED ON: FUND,DEPARTMENT  
 PAGE BREAKS ON: FUND

FUND - 11 - GENERAL FUND

ORGANIZATION / ACCOUNT / TITLE	BUDGET	PERIOD EXPENDITURES	ENCUMBRANCES OUTSTANDING	YEAR TO DATE EXP	AVAILABLE BALANCE
11-1111-000-0000-02315-0011 2820 EL.REG EMPLOYEE RET	689,151.79	53,375.43	.00	351,091.55	338,060.24
11-1111-000-0000-02315-0011 2821 EL.REG RETIREMT STU	384,656.38	32,794.89	.00	163,974.48	220,681.90
11-1111-000-0000-02315-0011 2830 EL.REG EMPLOYER SOC	214,044.37	15,183.82	.00	97,868.91	116,175.46
11-1111-000-0000-02315-0011 2840 EL.REG WORKMANS COM	1,660.00	.00	.00	1,660.00	.00
11-1111-000-0000-02315-0011 2850 EL.REG UNEMPLOYMENT	1,542.50	.00	.00	.00	1,542.50
11-1111-000-0000-02315-0011 2920 EL.REG CASH IN LIEU	110,241.00	7,810.22	.00	53,037.40	57,203.60
11-1111-000-0000-02315-0011 2990 EL.REG SICK DAY REI	7,328.00	.00	.00	.00	7,328.00
11-1111-000-0000-02315-0011 3110 EL.REG PURCHASED SE	42,073.00	4,725.90	.00	24,261.05	17,811.95
11-1111-000-0000-02315-0011 3112 EL.REG PURCH NWEA	3,585.00	.00	.00	3,022.80	562.20
11-1111-000-0000-02315-0011 3130 EL.REG NURSING	.00	.00	.00	2,943.00	-2,943.00
11-1111-000-0000-02315-0011 3220 EL.REG WKSHOPS/CONF	300.00	.00	.00	1,512.80	-1,212.80
11-1111-000-0000-02315-0011 3450 EL.REG SOFTWARE	10,750.00	444.19	.00	7,428.21	3,321.79
11-1111-000-0000-02315-0011 4120 EL.REG REPAIRS EQUI	500.00	.00	.00	.00	500.00
11-1111-000-0000-02315-0011 4190 EL.REG TECH REPAIRS	2,800.00	.00	.00	4,516.47	-1,716.47
11-1111-000-0000-02315-0011 4220 EL.REG RENTALS EQUI	8,545.00	416.39	.00	4,299.62	4,245.38
11-1111-000-0000-02315-0011 5110 EL.REG TEACHING SUP	42,000.00	3,547.00	2,221.20	62,174.36	-22,395.56
11-1111-000-0000-02315-0011 5119 EL.REG MIBLSI	.00	.00	.00	.00	.00
11-1111-000-0000-02315-0011 5123 EL.REG ISSI	.00	.00	.00	.00	.00
11-1111-000-0000-02315-0011 5210 EL.REG TEXTBOOKS	34,000.00	.00	.00	25,873.99	8,126.01
11-1111-000-0000-02315-0011 5990 EL.REG MISC. SUPPLI	2,600.00	.00	31.98	3,185.23	-617.21
11-1111-000-0000-02315-0011 5997 EL.REG TECH SUPPLIE	500.00	13.67	.00	354.49	145.51
11-1111-000-0000-02315-0011 6410 EL.REG NEW EQUIP/FU	10,000.00	.00	.00	6,108.13	3,891.87
11-1111-000-0000-02315-0011 6427 EL.REG TECH EQUIPME	60,000.00	439.59	-439.59	61,212.91	-773.32
11-1111-000-0000-02315-0011 7410 EL.REG DUES/FEES	7,875.00	.00	.00	18,926.47	-11,051.47
11-1111-000-0000-02315-0011 8220 EL.REG PAYMT TO ANO	6,600.00	.00	.00	5,200.08	1,399.92
11-1213-000-0000-02315-0011 3130 EL.REG.NURSE NURSIN	.00	38.68	113.18	1,450.77	-1,563.95
11-1259-000-0000-02315-0011 3990 EL.BUS STUDENT INS	6,909.00	.00	.00	6,588.25	320.75
TOTAL DEPARTMENT - ELEMENTARY INSTRUCTION	4,820,794.86	362,407.61	1,926.77	2,530,193.18	2,288,674.91
11-1113-000-0000-02316-0012 1240 HS.REG SALARY TEACH	1,428,227.90	110,322.31	.00	726,664.79	701,563.11
11-1113-000-0000-02316-0012 1242 HS.REG ISSI	.00	-2,233.71	.00	3,195.09	-3,195.09
11-1113-000-0000-02316-0012 1243 HS.REG PLTW	.00	.00	.00	.00	.00
11-1113-000-0000-02316-0012 1870 HS.REG SALARY-SUBST	3,335.00	35.00	.00	1,507.50	1,827.50
11-1113-000-0000-02316-0012 2130 HS.REG EMPLOYEE INS	322,137.09	24,340.29	.00	187,102.53	135,034.56
11-1113-000-0000-02316-0012 2210 HS.REG EARLY RETIRE	.00	.00	.00	.00	.00
11-1113-000-0000-02316-0012 2820 HS.REG EMPLOYEE RET	369,061.31	28,118.84	.00	187,026.22	182,035.09
11-1113-000-0000-02316-0012 2821 HS.REG RETIREMT STU	218,357.08	17,082.50	.00	85,412.48	132,944.60
11-1113-000-0000-02316-0012 2830 HS.REG EMPLOYER SOC	112,043.15	7,999.66	.00	52,597.43	59,445.72
11-1113-000-0000-02316-0012 2840 HS.REG WORKMANS COM	1,660.00	.00	.00	1,052.00	608.00
11-1113-000-0000-02316-0012 2850 HS.REG UNEMPLOYMENT	1,542.50	.00	.00	.00	1,542.50
11-1113-000-0000-02316-0012 2920 HS.REG CASH IN LIEU	26,244.00	2,533.20	.00	14,150.28	12,093.72
11-1113-000-0000-02316-0012 2990 HS.REG SICK DAY REI	7,350.00	.00	.00	.00	7,350.00
11-1113-000-0000-02316-0012 3110 HS.REG PURCHASED SE	25,051.00	1,070.10	.00	7,346.96	17,704.04
11-1113-000-0000-02316-0012 3112 HS.REG PURCH NWEA	2,510.00	.00	.00	1,580.10	929.90
11-1113-000-0000-02316-0012 3130 HS.REG NURSING	.00	.00	.00	.00	.00

SPI  
 DATE: 03/15/2019  
 TIME: 12:03:09

MADISON SCHOOL DISTRICT  
 DETAIL EXPENDITURE STATUS REPORT

PAGE NUMBER: 3  
 EXPSTA11

SELECTION CRITERIA: orgn.fund='11'  
 ACCOUNTING PERIOD: 8/19

SORTED BY: FUND,DEPARTMENT,FUNCTION,ACCOUNT  
 TOTALED ON: FUND,DEPARTMENT  
 PAGE BREAKS ON: FUND

FUND - 11 - GENERAL FUND

ORGANIZATION / ACCOUNT / TITLE	BUDGET	PERIOD EXPENDITURES	ENCUMBRANCES OUTSTANDING	YEAR TO DATE EXP	AVAILABLE BALANCE
11-1113-000-0000-02316-0012 3220 HS.REG WKSHOPS/CONF	900.00	.00	.00	548.39	351.61
11-1113-000-0000-02316-0012 3450 HS.REG SOFTWARE	15,000.00	307.51	.00	9,099.69	5,900.31
11-1113-000-0000-02316-0012 3710 HS.REG CAP	.00	.00	.00	.00	.00
11-1113-000-0000-02316-0012 3711 HS.REG TUITION COLL	45,001.00	.00	.00	5,645.00	39,356.00
11-1113-000-0000-02316-0012 4120 HS.REG REPAIRS EQUI	400.00	.00	.00	700.00	-300.00
11-1113-000-0000-02316-0012 4190 HS.REG TECH REPAIRS	1,700.00	.00	.00	924.18	775.82
11-1113-000-0000-02316-0012 4220 HS.REG RENTALS EQUI	12,800.00	490.04	.00	3,112.40	9,687.60
11-1113-000-0000-02316-0012 5110 HS.REG TEACHING SUP	15,000.00	2,244.58	603.40	17,526.20	-3,129.60
11-1113-000-0000-02316-0012 5121 HS.REG PLTW	10,000.00	.00	390.15	12,835.31	-3,225.46
11-1113-000-0000-02316-0012 5122 HS.REG CAREER PREP	3,000.00	563.13	.00	6,500.79	-3,500.79
11-1113-000-0000-02316-0012 5123 HS.REG ISSI	.00	.00	.00	.00	.00
11-1113-000-0000-02316-0012 5130 HS.REG GRADUATION E	2,700.00	16.75	.00	38.00	2,662.00
11-1113-000-0000-02316-0012 5210 HS.REG TEXTBOOKS	7,000.00	1,254.35	16.00	13,390.21	-6,406.21
11-1113-000-0000-02316-0012 5211 HS.REG 20/20 VIRTUA	.00	.00	.00	1,950.00	-1,950.00
11-1113-000-0000-02316-0012 5990 HS.REG MISC. SUPPLI	3,200.00	.00	.00	3,468.00	-268.00
11-1113-000-0696-02316-0012 5990 HS.REG.DRUG MISC. S	.00	.00	.00	.00	.00
11-1113-000-0000-02316-0012 5997 HS.REG TECH SUPPLIE	1,057.00	378.36	.00	1,600.30	-543.30
11-1113-000-0000-02316-0012 6410 HS.REG NEW EQUIP/FU	10,000.00	.00	.00	833.97	9,166.03
11-1113-000-0000-02316-0012 6427 HS.REG TECH EQUIPME	43,500.00	304.33	-304.33	37,340.83	6,463.50
11-1113-000-0000-02316-0012 6450 HS.REG EQUIP DEPR	2,000.00	570.88	496.14	9,393.31	-7,889.45
11-1113-000-0000-02316-0012 7410 HS.REG DUES/FEES	2,525.00	.00	.00	4,451.79	-1,926.79
11-1113-000-0000-02316-0012 8210 HS.REG PREP ACADEMY	11,000.00	.00	.00	8,404.00	2,596.00
11-1113-000-0000-02316-0012 8220 HS.REG PAYMT TO ANO	6,600.00	.00	.00	5,200.05	1,399.95
11-1213-000-0000-02316-0012 3130 HS.NURSE NURSING	.00	1.74	17.11	542.49	-559.60
11-1259-000-0000-02316-0012 3990 HS.BUS STUDENT INS	3,454.50	.00	.00	3,294.13	160.37
TOTAL DEPARTMENT - H.S. BASIC INSTRCT	2,714,356.53	195,399.86	1,218.47	1,414,434.42	1,298,703.64
11-1112-000-0000-07262-0013 1240 MS.REG SALARY TEACH	1,022,361.76	80,159.34	.00	529,315.01	493,046.75
11-1112-000-0000-07262-0013 1242 MS.REG ISSI	.00	-2,646.54	.00	3,687.06	-3,687.06
11-1112-000-0000-07262-0013 1243 MS.REG PLTW	3,000.00	.00	.00	2,626.20	373.80
11-1112-000-0000-07262-0013 1870 MS.REG SALARY-SUBST	1,650.00	.00	.00	3,132.50	-1,482.50
11-1112-000-0000-07262-0013 2130 MS.REG EMPLOYEE INS	206,815.58	17,090.51	.00	118,703.19	88,112.39
11-1112-000-0000-07262-0013 2820 MS.REG EMPLOYEE RET	263,389.15	20,430.72	.00	141,284.58	122,104.57
11-1112-000-0000-07262-0013 2821 MS.REG RETIREMT STU	157,082.09	12,950.51	.00	64,752.55	92,329.54
11-1112-000-0000-07262-0013 2830 MS.REG EMPLOYER SOC	82,074.86	5,855.99	.00	39,690.28	42,384.58
11-1112-000-0000-07262-0013 2840 MS.REG WORKMANS COM	793.00	.00	.00	793.00	.00
11-1112-000-0000-07262-0013 2850 MS.REG UNEMPLOYMENT	.00	.00	.00	.00	.00
11-1112-000-0000-07262-0013 2920 MS.REG CASH IN LIEU	43,842.19	3,466.22	.00	22,401.75	21,440.44
11-1112-000-0000-07262-0013 2990 MS.REG SICK DAY REI	3,150.00	.00	.00	.00	3,150.00
11-1112-000-0000-07262-0013 3110 MS.REG PURCHASED SE	21,688.00	1,162.30	.00	4,849.32	16,838.68
11-1112-000-0000-07262-0013 3112 MS.REG PURCH NWEA	5,500.00	.00	.00	2,267.10	3,232.90
11-1112-000-0000-07262-0013 3130 MS.REG NURSING	.00	.00	.00	.00	.00
11-1112-000-0000-07262-0013 3220 MS.REG WKSHOPS/CONF	200.00	.00	.00	861.36	-661.36
11-1112-000-0000-07262-0013 3228 MS.REG PLTW TRAVEL	.00	.00	.00	.00	.00
11-1112-000-0000-07262-0013 3450 MS.REG SOFTWARE	8,450.00	364.46	.00	3,357.92	5,092.08

SPI  
 DATE: 03/15/2019  
 TIME: 12:03:09

MADISON SCHOOL DISTRICT  
 DETAIL EXPENDITURE STATUS REPORT

PAGE NUMBER: 4  
 EXPSTALL

SELECTION CRITERIA: orgn.fund='11'  
 ACCOUNTING PERIOD: 8/19

SORTED BY: FUND,DEPARTMENT,FUNCTION,ACCOUNT  
 TOTALED ON: FUND,DEPARTMENT  
 PAGE BREAKS ON: FUND

FUND - 11 - GENERAL FUND

ORGANIZATION / ACCOUNT / TITLE	BUDGET	PERIOD EXPENDITURES	ENCUMBRANCES OUTSTANDING	YEAR TO DATE EXP	AVAILABLE BALANCE
11-1112-000-0000-07262-0013 4120 MS.REG REPAIRS EQUI	.00	.00	.00	.00	.00
11-1112-000-0000-07262-0013 4190 MS.REG TECH REPAIRS	2,200.00	.00	.00	920.81	1,279.19
11-1112-000-0000-07262-0013 4220 MS.REG RENTALS EQUI	4,000.00	299.46	.00	2,433.25	1,566.75
11-1112-000-0000-07262-0013 5110 MS.REG TEACHING SUP	13,000.00	1,761.00	2,591.11	9,286.76	1,122.13
11-1112-000-0000-07262-0013 5119 MS.REG MIBLSI	.00	.00	.00	.00	.00
11-1112-000-0000-07262-0013 5121 MS.REG PLTW	8,500.00	84.90	.00	2,227.55	6,272.45
11-1112-000-0000-07262-0013 5122 MS.REG CAREER PREP	.00	.00	.00	1,419.95	-1,419.95
11-1112-000-0000-07262-0013 5123 MS.REG ISSI	.00	.00	.00	.00	.00
11-1112-000-0000-07262-0013 5210 MS.REG TEXTBOOKS	4,000.00	.00	.00	20,796.33	-16,796.33
11-1112-000-0000-07262-0013 5990 MS.REG MISC. SUPPLI	3,000.00	5,168.00	.00	5,168.00	-2,168.00
11-1112-000-0000-07262-0013 5997 MS.REG TECH SUPPLIE	400.00	50.54	.00	602.83	-202.83
11-1112-000-0000-07262-0013 6410 MS.REG NEW EQUIP/FU	5,000.00	.00	.00	1,778.97	3,221.03
11-1112-000-0000-07262-0013 6427 MS.REG TECH EQUIPME	54,500.00	859.69	-360.69	43,928.31	10,932.38
11-1112-000-0000-07262-0013 6450 MS.REG EQUIP DEPR	1,600.00	146.98	76.20	3,126.93	-1,603.13
11-1112-000-0000-07262-0013 7410 MS.REG DUES/FEES	2,485.00	.00	.00	3,565.78	-1,080.78
11-1112-000-0000-07262-0013 8220 MS.REG PAYMT TO ANO	6,600.00	.00	.00	5,200.07	1,399.93
11-1213-000-0000-07262-0013 3130 MS.NURSE NURSING	.00	1.75	17.12	559.27	-576.39
11-1259-000-0000-07262-0013 3990 MS. BUS STUDENT INS	3,454.50	.00	.00	3,294.12	160.38
TOTAL DEPARTMENT - M.S. BASIC INSTRUCT	1,928,736.13	147,205.83	2,323.74	1,042,030.75	884,381.64
11-1113-000-0375-02316-0015 1240 HS.REG.DRIVER SALAR	6,859.31	20.79	.00	3,388.77	3,470.54
11-1113-000-0375-02316-0015 2820 HS.REG.DRIVER EMPLO	1,753.24	5.44	.00	869.39	883.85
11-1113-000-0375-02316-0015 2821 HS.REG.DRIVER RETIR	908.74	86.99	.00	434.95	473.79
11-1113-000-0375-02316-0015 2830 HS.REG.DRIVER EMPLO	525.00	1.49	.00	242.74	282.26
11-1113-000-0375-02316-0015 4120 HS.REG.DRIVER REPAI	.00	.00	.00	.00	.00
11-1113-000-0375-02316-0015 5110 HS.REG.DRIVER TEACH	200.00	.00	.00	.00	200.00
TOTAL DEPARTMENT - DRIVERS EDUCATION	10,246.29	114.71	.00	4,935.85	5,310.44
11-1122-194-0202-02315-0016 1240 EL.SPEC.RES SALARY	711,144.20	53,624.08	.00	348,703.56	362,440.64
11-1122-194-0202-02316-0016 1240 HS.SPEC.RES SALARY	.00	.00	.00	.00	.00
11-1122-194-0202-07262-0016 1240 MS.SPEC.RES SALARY	.00	.00	.00	30.00	-30.00
11-1122-193-0202-02315-0016 1632 EL.SPEC.AI AIDE-AI	119,275.56	14,421.92	.00	119,158.19	117.37
11-1122-110-0202-02315-0016 1634 EL.SPEC.EMI AIDE-MC	29,724.30	1,236.20	.00	9,763.74	19,960.56
11-1122-110-0202-02316-0016 1636 HS.SPEC.EMI AIDE -	29,415.23	1,034.37	.00	8,773.02	20,642.21
11-1122-196-0202-02316-0016 1638 HS.SPEC.LRE LRE AID	119,237.85	9,314.96	.00	76,184.00	43,053.85
11-1122-194-0202-02315-0016 1870 EL.SPEC.RES SALARY-	205.00	.00	.00	2,242.58	-2,037.58
11-1122-194-0202-02315-0016 2130 EL.SPEC.RES EMPLOYE	168,634.28	14,155.23	.00	100,321.97	68,312.31
11-1122-194-0202-02315-0016 2210 EL.SPEC.RES EARLY R	.00	.00	.00	.00	.00
11-1122-193-0202-02315-0016 2820 EL.SPEC.AI EMPLOYEE	.00	4,077.41	.00	33,434.94	-33,434.94
11-1122-110-0202-02315-0016 2820 EL.SPEC.EMI EMPLOYEE	.00	313.87	.00	2,477.89	-2,477.89
11-1122-194-0202-02315-0016 2820 EL.SPEC.RES EMPLOYE	265,557.77	14,092.71	.00	92,142.14	173,415.63
11-1122-110-0202-02316-0016 2820 HS.SPEC.EMI EMPLOYE	.00	270.80	.00	2,291.95	-2,291.95
11-1122-196-0202-02316-0016 2820 HS.SPEC.LRE EMPLOYE	.00	2,631.73	.00	20,973.49	-20,973.49
11-1122-194-0202-02316-0016 2820 HS.SPEC.RES EMPLOYE	.00	.00	.00	.00	.00

SPI  
 DATE: 03/15/2019  
 TIME: 12:03:09

MADISON SCHOOL DISTRICT  
 DETAIL EXPENDITURE STATUS REPORT

PAGE NUMBER: 5  
 EXPSTA11

SELECTION CRITERIA: orgn.fund='11'  
 ACCOUNTING PERIOD: 8/19

SORTED BY: FUND,DEPARTMENT,FUNCTION,ACCOUNT  
 TOTALED ON: FUND,DEPARTMENT  
 PAGE BREAKS ON: FUND

FUND - 11 - GENERAL FUND

ORGANIZATION / ACCOUNT / TITLE	BUDGET	PERIOD EXPENDITURES	ENCUMBRANCES OUTSTANDING	YEAR TO DATE EXP	AVAILABLE BALANCE
11-1122-194-0202-07262-0016 2820 MS.SPEC.RES EMPLOYE	.00	.00	.00	7.85	-7.85
11-1122-194-0202-02315-0016 2821 EL.SPEC.RES RETIREM	143,191.36	12,493.82	.00	62,469.10	80,722.26
11-1122-193-0202-02315-0016 2830 EL.SPEC.AI EMPLOYER	.00	1,098.14	.00	9,034.82	-9,034.82
11-1122-110-0202-02315-0016 2830 EL.SPEC.EMI EMPLOYE	.00	91.73	.00	724.68	-724.68
11-1122-194-0202-02315-0016 2830 EL.SPEC.RES EMPLOYE	75,926.26	3,905.84	.00	24,947.50	50,978.76
11-1122-110-0202-02316-0016 2830 HS.SPEC.EMI EMPLOYE	.00	76.76	.00	651.01	-651.01
11-1122-196-0202-02316-0016 2830 HS.SPEC.LRE EMPLOYE	.00	706.66	.00	5,781.65	-5,781.65
11-1122-194-0202-02316-0016 2830 HS.SPEC.RES EMPLOYE	.00	.00	.00	.00	.00
11-1122-194-0202-07262-0016 2830 MS.SPEC.RES EMPLOYE	.00	.00	.00	2.23	-2.23
11-1122-194-0202-02315-0016 2840 EL.SPEC.RES WORKMAN	554.00	.00	.00	554.00	.00
11-1122-194-0202-02315-0016 2920 EL.SPEC.RES CASH IN	6,561.00	504.66	.00	3,280.29	3,280.71
11-1122-194-0202-02315-0016 2990 EL.SPEC.RES SICK DA	1,550.00	.00	.00	.00	1,550.00
11-1122-194-0202-02315-0016 3110 EL.SPEC.RES PURCHAS	5,300.00	430.70	.00	7,656.79	-2,356.79
11-1122-194-0202-02315-0016 3113 EL.SPEC.RES HAVILAN	35,264.00	.00	.00	.00	35,264.00
11-1122-194-0202-02316-0016 3221 HS.SPEC.RES TRAVEL	.00	35.00	.00	484.99	-484.99
11-1122-194-0202-02315-0016 3222 EL.SPEC.RES TRAVEL	.00	.00	.00	1,139.97	-1,139.97
11-1122-110-0202-02315-0016 3224 EL.SPEC.EMI TRAVEL	.00	.00	.00	.00	.00
11-1122-110-0202-02316-0016 3226 HS.SPEC.EMI TRAVEL	.00	.00	.00	.00	.00
11-1122-194-0202-02315-0016 4220 EL.SPEC.RES RENTALS	375.00	24.61	.00	213.35	161.65
11-1122-170-0202-07262-0016 5110 HS.SPEC.VI TEACHING	.00	.00	.00	.00	.00
11-1122-194-0202-02316-0016 5111 HS.SPEC.RES SUPPLIE	650.00	.00	.00	126.66	523.34
11-1122-194-0202-02315-0016 5112 EL.SPEC.RES SUPPLIE	1,350.00	.00	.00	3,540.71	-2,190.71
11-1122-110-0202-02315-0016 5114 EL.SPEC.EMI SUPPLIE	500.00	.00	.00	619.12	-119.12
11-1122-110-0202-02316-0016 5116 HS.SPEC.EMI SUPPLIE	.00	.00	.00	802.93	-802.93
11-1122-194-0202-02316-0016 5991 HS.SPEC.RES MISC HS	25.00	.00	.00	.00	25.00
11-1122-194-0202-02315-0016 5992 EL.SPEC.RES MISC EL	.00	.00	.00	28.91	-28.91
11-1122-110-0202-02315-0016 5994 EL.SPEC.EMI MISC MC	.00	.00	.00	.00	.00
11-1122-110-0202-02316-0016 5996 HS.SPEC.EMI MISC SE	.00	.00	.00	.00	.00
11-1122-194-0202-02316-0016 6421 HS.SPEC.RES FURN/EQ	.00	.00	.00	.00	.00
11-1122-194-0202-02315-0016 6422 EL.SPEC.RES FURN/EQ	25.00	47.98	.00	47.98	-22.98
11-1122-110-0202-02315-0016 6424 EL.SPEC.EMI FURN/EQ	.00	.00	.00	.00	.00
11-1122-110-0202-02316-0016 6426 HS.SPEC.EMI FURN/EQ	100.00	.00	.00	.00	100.00
11-1122-194-0202-02315-0016 7410 EL.SPEC.RES DUES/FE	90.00	.00	.00	609.00	-519.00
TOTAL DEPARTMENT - SPECIAL EDUCATION	1,714,655.81	134,589.18	.00	939,221.01	775,434.80
11-1125-000-0601-02315-0017 1240 EL.COMP.TTL 1 SALAR	.00	.00	.00	.00	.00
11-1125-000-0601-02316-0017 1240 HS.COMP.TTL 1 SALAR	3,136.00	.00	.00	.00	3,136.00
11-1125-000-0601-02315-0017 1241 EL.COMP.TTL 1 SALAR	.00	.00	.00	.00	.00
11-1125-000-0601-02315-0017 1250 EL.COMP.TTL 1 INSTR	.00	.00	.00	.00	.00
11-1125-000-0601-02315-0017 1290 EL.COMP.TTL 1 OTHER	8,679.90	675.00	.00	5,737.50	2,942.40
11-1125-000-0601-02315-0017 1630 EL.COMP.TTL 1 SALAR	78,406.02	6,673.50	.00	51,107.08	27,298.94
11-1125-000-0601-02315-0017 1635 EL.COMP.TTL 1 STUDE	.00	.00	.00	.00	.00
11-1125-000-0601-02315-0017 1637 EL.COMP.TTL 1 AIDE	44,223.60	3,452.32	.00	22,440.08	21,783.52
11-1125-000-0601-02315-0017 2130 EL.COMP.TTL 1 EMPLO	9,721.19	3,392.24	.00	10,854.77	-1,133.58
11-1125-000-0601-02315-0017 2820 EL.COMP.TTL 1 EMPLO	70,329.35	2,923.44	.00	21,495.01	48,834.34

SPI  
 DATE: 03/15/2019  
 TIME: 12:03:09

MADISON SCHOOL DISTRICT  
 DETAIL EXPENDITURE STATUS REPORT

PAGE NUMBER: 6  
 EXPSTA11

SELECTION CRITERIA: orgn.fund='11'  
 ACCOUNTING PERIOD: 8/19

SORTED BY: FUND,DEPARTMENT,FUNCTION,ACCOUNT  
 TOTALED ON: FUND,DEPARTMENT  
 PAGE BREAKS ON: FUND

FUND - 11 - GENERAL FUND

ORGANIZATION / ACCOUNT / TITLE	BUDGET	PERIOD EXPENDITURES	ENCUMBRANCES OUTSTANDING	YEAR TO DATE EXP	AVAILABLE BALANCE
11-1125-000-0601-02316-0017 2820 HS.COMP.TTL 1 EMPLO	.00	.00	.00	.00	.00
11-1125-000-0601-02315-0017 2821 EL.COMP.TTL 1 RETIR	.00	.00	.00	.00	.00
11-1125-000-0601-02315-0017 2830 EL.COMP.TTL 1 EMPLO	20,975.38	812.07	.00	5,952.05	15,023.33
11-1125-000-0601-02316-0017 2830 HS.COMP.TTL 1 EMPLO	.00	.00	.00	.00	.00
11-1125-000-0601-02315-0017 2840 EL.COMP.TTL 1 WORKM	.00	.00	.00	.00	.00
11-1125-000-0601-02315-0017 2920 EL.COMP.TTL 1 CASH	8,988.57	.00	.00	.00	8,988.57
11-1125-000-0601-02315-0017 2990 EL.COMP.TTL 1 SICK	.00	.00	.00	.00	.00
11-1125-000-0601-02315-0017 3220 EL.COMP.TTL 1 WKSHO	300.00	.00	.00	.00	300.00
11-1125-000-0601-02315-0017 4220 EL.COMP.TTL 1 RENTA	.00	.00	.00	.00	.00
11-1125-000-0601-02315-0017 5110 EL.COMP.TTL 1 TEACH	500.00	.00	.00	.00	500.00
11-1125-000-0601-02316-0017 5110 HS.COMP.TTL 1 TEACH	275.00	.00	.00	.00	275.00
11-1125-000-0601-02315-0017 6410 EL.COMP.TTL 1 NEW E	.00	.00	.00	.00	.00
11-1125-000-0601-02315-0017 8220 EL.COMP.TTL 1 PAYMT	.00	.00	.00	.00	.00
11-1212-000-0601-02315-0017 1220 EL.COUN.TTL 1 SALAR	24,562.30	1,862.50	.00	12,106.25	12,456.05
11-1212-000-0601-02315-0017 2130 EL.COUN.TTL 1 EMPLO	.00	.00	.00	.00	.00
11-1212-000-0601-02315-0017 2820 EL.COUN.TTL 1 EMPLO	.00	487.60	.00	3,157.86	-3,157.86
11-1212-000-0601-02315-0017 2830 EL.COUN.TTL 1 EMPLO	.00	148.36	.00	952.69	-952.69
11-1212-000-0601-02315-0017 2920 EL.COUN.TTL 1 CASH	.00	176.64	.00	1,148.16	-1,148.16
11-1213-000-0601-02315-0017 3130 EL.NURSE.TTL 1 NURS	.00	.00	.00	.00	.00
11-1221-000-0601-02315-0017 1250 EL.INST.TTL 1 INSTR	89,683.40	6,813.14	.00	57,911.69	31,771.71
11-1221-000-0601-02315-0017 2130 EL.INST.TTL 1 EMPLO	.00	.00	.00	.00	.00
11-1221-000-0601-02315-0017 2820 EL.INST.TTL 1 EMPLO	.00	1,783.66	.00	15,034.39	-15,034.39
11-1221-000-0601-02315-0017 2830 EL.INST.TTL 1 EMPLO	.00	527.74	.00	4,509.26	-4,509.26
11-1221-000-0601-02315-0017 2920 EL.INST.TTL 1 CASH	.00	403.72	.00	3,431.62	-3,431.62
11-1226-000-0601-02315-0017 1160 EL.DIR.TTL 1 SALARY	20,247.92	1,574.46	.00	13,382.91	6,865.01
11-1226-000-0601-02315-0017 2130 EL.DIR.TTL 1 EMPLOY	.00	.00	.00	.00	.00
11-1226-000-0601-02315-0017 2820 EL.DIR.TTL 1 EMPLOY	.00	412.20	.00	3,474.42	-3,474.42
11-1226-000-0601-02315-0017 2830 EL.DIR.TTL 1 EMPLOY	.00	125.34	.00	1,065.39	-1,065.39
11-1226-000-0601-02315-0017 2920 EL.DIR.TTL 1 CASH I	.00	111.02	.00	943.67	-943.67
11-1231-000-0601-02315-0017 3180 EL.BOE.TTL 1 AUDIT	900.00	.00	.00	900.00	.00
TOTAL DEPARTMENT - TITLE I	380,928.63	32,354.95	.00	235,604.80	145,323.83
11-1125-000-0306-02315-0018 1220 EL.COMP.AR SALARY C	17,544.50	1,330.34	.00	8,647.20	8,897.30
11-1125-000-0306-07262-0018 1220 MS.COMP.AR SALARY C	67,222.80	5,101.76	.00	33,161.43	34,061.37
11-1125-000-0306-02315-0018 1240 EL.COMP.AR SALARY T	.00	-6.55	.00	-6.55	6.55
11-1125-000-0306-02316-0018 1240 HS.COMP.AR SALARY T	.00	.00	.00	.00	.00
11-1125-000-0306-07262-0018 1240 MS.COMP.AR SALARY T	37,457.55	2,837.50	.00	18,443.75	19,013.80
11-1125-000-0306-02315-0018 1250 EL.COMP.AR INSTR SP	14,764.60	1,120.36	.00	9,523.06	5,241.54
11-1125-000-0306-02315-0018 1290 EL.COMP.AR OTHER PR	90,892.50	6,953.26	.00	59,102.71	31,789.79
11-1125-000-0306-02316-0018 1290 HS.COMP.AR OTHER PR	53,329.00	4,033.00	.00	34,280.50	19,048.50
11-1125-000-0306-02315-0018 1450 EL.COMP.AR SCHOOL N	20,000.00	.00	.00	.00	20,000.00
11-1125-000-0306-02315-0018 1630 EL.COMP.AR SALARY A	92,241.97	5,839.84	.00	49,108.33	43,133.64
11-1125-000-0306-02315-0018 1631 EL.COMP.AR TUTOR	6,356.96	.00	.00	2,242.43	4,114.53
11-1125-000-0306-02316-0018 1631 HS.COMP.AR TUTOR	4,008.96	440.96	.00	3,334.12	674.84
11-1125-000-0306-07262-0018 1631 MS.COMP.AR TUTOR	9,373.00	546.05	.00	4,641.48	4,731.52

SPI  
 DATE: 03/15/2019  
 TIME: 12:03:09

MADISON SCHOOL DISTRICT  
 DETAIL EXPENDITURE STATUS REPORT

PAGE NUMBER: 7  
 EXPSTA11

SELECTION CRITERIA: orgn.fund='11'  
 ACCOUNTING PERIOD: 8/19

SORTED BY: FUND,DEPARTMENT,FUNCTION,ACCOUNT  
 TOTALED ON: FUND,DEPARTMENT  
 PAGE BREAKS ON: FUND

FUND - 11 - GENERAL FUND

ORGANIZATION / ACCOUNT / TITLE	BUDGET	PERIOD EXPENDITURES	ENCUMBRANCES OUTSTANDING	YEAR TO DATE EXP	AVAILABLE BALANCE
11-1125-000-0306-02315-0018 1633 EL.COMP.AR EARLY LI	26,328.00	1,825.18	.00	11,863.67	14,464.33
11-1125-000-0306-02315-0018 1637 EL.COMP.AR AIDE - S	.00	.00	.00	.00	.00
11-1125-000-0306-07262-0018 1637 MS.COMP.AR AIDE - S	27,296.10	2,031.34	.00	15,982.37	11,313.73
11-1125-000-0306-02315-0018 1870 EL.COMP.AR SALARY-S	.00	.00	.00	.00	.00
11-1125-000-0306-02315-0018 2130 EL.COMP.AR EMPLOYEE	27,197.25	7,085.21	.00	17,768.60	9,428.65
11-1125-000-0306-02316-0018 2130 HS.COMP.AR EMPLOYEE	.00	.00	.00	2,000.00	-2,000.00
11-1125-000-0306-02315-0018 2210 EL.COMP.AR EARLY RE	.00	.00	.00	.00	.00
11-1125-000-0306-07262-0018 2210 MS.COMP.AR EARLY RE	.00	.00	.00	.00	.00
11-1125-000-0306-02315-0018 2820 EL.COMP.AR EMPLOYEE	122,806.49	4,567.62	.00	37,314.61	85,491.88
11-1125-000-0306-02316-0018 2820 HS.COMP.AR EMPLOYEE	.00	1,171.25	.00	9,775.07	-9,775.07
11-1125-000-0306-07262-0018 2820 MS.COMP.AR EMPLOYEE	.00	2,733.57	.00	18,661.14	-18,661.14
11-1125-000-0306-02315-0018 2821 EL.COMP.AR RETIREMT	65,818.69	5,773.91	.00	28,869.54	36,949.15
11-1125-000-0306-02315-0018 2830 EL.COMP.AR EMPLOYER	36,712.19	1,310.25	.00	10,749.49	25,962.70
11-1125-000-0306-02316-0018 2830 HS.COMP.AR EMPLOYER	.00	313.62	.00	2,990.48	-2,990.48
11-1125-000-0306-07262-0018 2830 MS.COMP.AR EMPLOYER	.00	778.94	.00	5,299.32	-5,299.32
11-1125-000-0306-02315-0018 2840 EL.COMP.AR WORKMANS	350.00	.00	.00	350.00	.00
11-1125-000-0306-02315-0018 2920 EL.COMP.AR CASH IN	12,793.95	479.44	.00	3,822.92	8,971.03
11-1125-000-0306-02316-0018 2920 HS.COMP.AR CASH IN	.00	.00	.00	3,280.29	-3,280.29
11-1125-000-0306-02315-0018 2990 EL.COMP.AR SICK DAY	288.00	.00	.00	.00	288.00
11-1125-000-0306-07262-0018 2990 MS.COMP.AR SICK DAY	.00	.00	.00	.00	.00
11-1125-000-0306-02315-0018 3110 EL.COMP.AR PURCHASE	.00	2,700.00	.00	2,700.00	-2,700.00
11-1125-000-0306-02315-0018 3220 EL.COMP.AR WKSHOPS/	240.00	.00	.00	.00	240.00
11-1125-000-0306-07262-0018 3220 MS.COMP.AR WKSHOPS/	.00	.00	.00	.00	.00
11-1125-000-0306-02315-0018 3227 EL.COMP.AR TRAVE &	.00	.00	.00	.00	.00
11-1125-000-0306-02315-0018 5110 EL.COMP.AR TEACHING	.00	.00	.00	.00	.00
11-1125-000-0306-02315-0018 5117 EL.COMP.AR TEACHING	.00	.00	.00	.00	.00
11-1125-000-0306-02315-0018 5118 EL.COMP.AR STUDENT	.00	.00	.00	.00	.00
11-1125-000-0306-02315-0018 5990 EL.COMP.AR MISC. SU	.00	.00	.00	.00	.00
11-1125-000-0306-02315-0018 6410 EL.COMP.AR NEW EQUI	.00	.00	.00	.00	.00
11-1125-000-0306-02315-0018 6417 EL.COMP.AR EQUIP/FU	.00	.00	.00	.00	.00
11-1213-000-0306-02315-0018 3130 EL.NURSE.AR NURSING	.00	.00	.00	.00	.00
TOTAL DEPARTMENT - AT RISK	733,022.51	58,966.85	.00	393,905.96	339,116.55
11-1221-000-0764-02315-0019 1240 EL.TITLE II A SALAR	2,142.18	.00	.00	.00	2,142.18
11-1221-000-0764-02316-0019 1240 HS.TITLE II A SALAR	4,414.70	3,506.10	.00	3,506.10	908.60
11-1221-000-0764-07262-0019 1240 MS.TITLE II A SALAR	3,864.96	3,144.18	.00	3,144.18	720.78
11-1221-000-0764-02315-0019 2820 EL.TITLE II A EMPLO	2,646.56	.00	.00	.00	2,646.56
11-1221-000-0764-02316-0019 2820 HS.TITLE II A EMPLO	.00	809.58	.00	809.58	-809.58
11-1221-000-0764-07262-0019 2820 MS.TITLE II A EMPLO	.00	822.33	.00	822.33	-822.33
11-1221-000-0764-02315-0019 2830 EL.TITLE II A EMPLO	754.59	.00	.00	.00	754.59
11-1221-000-0764-02316-0019 2830 HS.TITLE II A EMPLO	.00	250.25	.00	250.25	-250.25
11-1221-000-0764-07262-0019 2830 MS.TITLE II A EMPLO	.00	228.22	.00	228.22	-228.22
11-1221-000-0764-02315-0019 3120 EL.TITLE II A EMPLO	12,217.51	.00	.00	16,852.24	-4,634.73
11-1221-000-0764-02316-0019 3120 HS.TITLE II A EMPLO	1,021.60	.00	.00	39.50	982.10
11-1221-000-0764-07262-0019 3120 MS.TITLE II A EMPLO	1,513.22	.00	.00	426.50	1,086.72

SPI  
 DATE: 03/15/2019  
 TIME: 12:03:09

MADISON SCHOOL DISTRICT  
 DETAIL EXPENDITURE STATUS REPORT

PAGE NUMBER: 8  
 EXPSTA11

SELECTION CRITERIA: orgn.fund='11'  
 ACCOUNTING PERIOD: 8/19

SORTED BY: FUND,DEPARTMENT,FUNCTION,ACCOUNT  
 TOTALED ON: FUND,DEPARTMENT  
 PAGE BREAKS ON: FUND

FUND - 11 - GENERAL FUND

ORGANIZATION / ACCOUNT / TITLE	BUDGET	PERIOD EXPENDITURES	ENCUMBRANCES OUTSTANDING	YEAR TO DATE EXP	AVAILABLE BALANCE
11-1221-000-0764-02315-0019 5110 EL.TITLE II A TEACH	.00	.00	.00	.00	.00
11-1221-000-0764-02316-0019 5990 HS.TITLE II A MISC.	.00	.00	.00	.00	.00
11-1221-000-0764-02315-0019 6410 EL.TITLE II A NEW E	.00	.00	.00	.00	.00
11-1221-000-0764-02315-0019 7410 EL.TITLE II A DUES/	.00	.00	.00	.00	.00
TOTAL DEPARTMENT - TITLE II TEACHER TRAININ	28,575.32	8,760.66	.00	26,078.90	2,496.42
11-1125-000-0341-02315-0020 1240 EL.COMP.SS SALARY T	2,509.00	.00	.00	2,714.40	-205.40
11-1125-000-0341-02315-0020 1630 EL.COMP.SS SALARY A	283.00	.00	.00	158.40	124.60
11-1125-000-0341-02315-0020 2130 EL.COMP.SS EMPLOYEE	.00	.00	.00	.00	.00
11-1125-000-0341-02315-0020 2820 EL.COMP.SS EMPLOYEE	994.00	.00	.00	734.29	259.71
11-1125-000-0341-02315-0020 2830 EL.COMP.SS EMPLOYER	295.48	.00	.00	206.63	88.85
11-1125-000-0341-02315-0020 2840 EL.COMP.SS WORKMANS	.00	.00	.00	.00	.00
11-1125-000-0341-02315-0020 3220 EL.COMP.SS WKSHOPS/	.00	.00	.00	.00	.00
11-1125-000-0341-02315-0020 5110 EL.COMP.SS TEACHING	.00	.00	.00	.00	.00
11-1125-000-0341-02315-0020 6410 EL.COMP.SS NEW EQUI	.00	.00	.00	.00	.00
11-1226-000-0341-02315-0020 1160 EL.DIR.SS SALARY SC	.00	.00	.00	.00	.00
11-1226-000-0341-02315-0020 2820 EL.DIR.SS EMPLOYEE	.00	.00	.00	.00	.00
11-1226-000-0341-02315-0020 2830 EL.DIR.SS EMPLOYER	.00	.00	.00	.00	.00
11-1261-000-0341-02315-0020 5790 EL.OPER.SS TRANSPOR	400.00	.00	.00	.00	400.00
11-1271-000-0341-02315-0020 1610 EL.TRANS.SS SALARY	1,175.00	.00	.00	899.62	275.38
11-1271-000-0341-02315-0020 2820 EL.TRANS.SS EMPLOYE	.00	.00	.00	227.43	-227.43
11-1271-000-0341-02315-0020 2830 EL.TRANS.SS EMPLOYE	.00	.00	.00	66.75	-66.75
TOTAL DEPARTMENT - SUMMER SCHOOL	5,656.48	.00	.00	5,007.52	648.96
11-1125-000-0307-02315-0021 1630 EL.COMP.BILING SALA	.00	.00	.00	.00	.00
11-1125-000-0307-02316-0021 1630 HS.COMP.BILING SALA	.00	.00	.00	.00	.00
11-1125-000-0307-07262-0021 1630 MS.COMP.BILING SALA	9,431.10	.00	.00	.00	9,431.10
11-1125-000-0307-02315-0021 2130 EL.COMP.BILING EMPL	.00	.00	.00	.00	.00
11-1125-000-0307-02315-0021 2820 EL.COMP.BILING EMPL	2,825.56	.00	.00	.00	2,825.56
11-1125-000-0307-02316-0021 2820 HS.COMP.BILING EMPL	.00	.00	.00	.00	.00
11-1125-000-0307-07262-0021 2820 MS.COMP.BILING EMPL	.00	.00	.00	.00	.00
11-1125-000-0307-02315-0021 2830 EL.COMP.BILING EMPL	721.48	.00	.00	.00	721.48
11-1125-000-0307-02316-0021 2830 HS.COMP.BILING EMPL	.00	.00	.00	.00	.00
11-1125-000-0307-07262-0021 2830 MS.COMP.BILING EMPL	.00	.00	.00	.00	.00
11-1125-000-0307-02315-0021 3220 EL.COMP.BILING WKSH	.00	.00	.00	.00	.00
11-1125-000-0307-02315-0021 5110 EL.COMP.BILING TEAC	.00	.00	.00	.00	.00
TOTAL DEPARTMENT - BILINGUAL	12,978.14	.00	.00	.00	12,978.14
11-1125-000-0768-02315-0022 1290 EL.TITLE.VI OTHER P	17,749.80	1,349.98	.00	11,474.83	6,274.97
11-1125-000-0768-02315-0022 2130 EL.TITLE.VI EMPLOYE	4,196.38	727.14	.00	2,375.96	1,820.42
11-1125-000-0768-02315-0022 2820 EL.TITLE.VI EMPLOYE	4,536.85	353.42	.00	2,978.99	1,557.86
11-1125-000-0768-02315-0022 2821 EL.TITLE.VI RETIREM	.00	.00	.00	.00	.00
11-1125-000-0768-02315-0022 2830 EL.TITLE.VI EMPLOYE	1,357.86	100.16	.00	851.36	506.50

SPI  
 DATE: 03/15/2019  
 TIME: 12:03:09

MADISON SCHOOL DISTRICT  
 DETAIL EXPENDITURE STATUS REPORT

PAGE NUMBER: 9  
 EXPSTALL

SELECTION CRITERIA: orgn.fund='11'  
 ACCOUNTING PERIOD: 8/19

SORTED BY: FUND,DEPARTMENT,FUNCTION,ACCOUNT  
 TOTALED ON: FUND,DEPARTMENT  
 PAGE BREAKS ON: FUND

FUND - 11 - GENERAL FUND

ORGANIZATION / ACCOUNT / TITLE	BUDGET	PERIOD EXPENDITURES	ENCUMBRANCES OUTSTANDING	YEAR TO DATE EXP	AVAILABLE BALANCE
TOTAL DEPARTMENT - TITLE VI RURAL	27,840.89	2,530.70	.00	17,681.14	10,159.75
11-1125-000-0753-02315-0023 1630 EL.TITLE IV SSAE SA	.00	.00	.00	.00	.00
11-1125-000-0753-02315-0023 2820 EL.TITLE IV SSAE EM	.00	.00	.00	.00	.00
11-1125-000-0753-02315-0023 2830 EL.TITLE IV SSAE EM	.00	.00	.00	.00	.00
TOTAL DEPARTMENT - TITLE IV SSAE	.00	.00	.00	.00	.00
11-1212-000-0000-02315-0025 1220 EL.COUN SALARY COUN	24,562.30	1,862.48	.00	12,106.12	12,456.18
11-1212-000-0000-02316-0025 1220 HS.COUN SALARY COUN	68,898.00	5,319.08	.00	45,212.18	23,685.82
11-1212-000-0000-07262-0025 1220 MS.COUN SALARY COUN	7,469.20	566.86	.00	3,628.74	3,840.46
11-1212-000-0000-02316-0025 1620 HS.COUN SALARY-SECR	38,319.68	2,774.97	.00	19,317.15	19,002.53
11-1212-000-0000-02315-0025 2130 EL.COUN EMPLOYEE IN	663.66	128.95	.00	1,027.02	-363.36
11-1212-000-0000-02316-0025 2130 HS.COUN EMPLOYEE IN	8,840.84	1,890.24	.00	5,787.15	3,053.69
11-1212-000-0000-07262-0025 2130 MS.COUN EMPLOYEE IN	728.01	.00	.00	.00	728.01
11-1212-000-0000-02315-0025 2210 EL.COUN EARLY RETIR	.00	.00	.00	.00	.00
11-1212-000-0000-02315-0025 2820 EL.COUN EMPLOYEE RE	6,188.66	487.60	.00	3,157.87	3,030.79
11-1212-000-0000-02316-0025 2820 HS.COUN EMPLOYEE RE	25,425.30	2,008.28	.00	15,725.39	9,699.91
11-1212-000-0000-07262-0025 2820 MS.COUN EMPLOYEE RE	1,909.13	148.40	.00	959.65	949.48
11-1212-000-0000-02315-0025 2821 EL.COUN RETIREMT ST	24,535.96	2,163.86	.00	10,819.30	13,716.66
11-1212-000-0000-02315-0025 2830 EL.COUN EMPLOYER SO	2,203.58	148.38	.00	952.79	1,250.79
11-1212-000-0000-02316-0025 2830 HS.COUN EMPLOYER SO	9,205.99	618.29	.00	4,954.56	4,251.43
11-1212-000-0000-07262-0025 2830 MS.COUN EMPLOYER SO	617.29	41.72	.00	266.42	350.87
11-1212-000-0000-02315-0025 2920 EL.COUN CASH IN LIE	2,296.35	176.62	.00	1,148.03	1,148.32
11-1212-000-0000-02316-0025 2920 HS.COUN CASH IN LIE	6,561.00	504.66	.00	4,289.61	2,271.39
11-1212-000-0000-02316-0025 2990 HS.COUN SICK DAY RE	.00	.00	.00	.00	.00
11-1212-000-0000-07262-0025 2990 MS.COUN SICK DAY RE	600.00	.00	.00	.00	600.00
11-1212-000-0000-02315-0025 3220 EL.COUN WKSHOPS/CON	.00	.00	.00	145.00	-145.00
11-1212-000-0000-02316-0025 3220 HS.COUN WKSHOPS/CON	130.00	.00	.00	574.00	-444.00
11-1212-000-0000-02315-0025 5120 EL.COUN TESTING SUP	960.00	.00	.00	1,149.00	-189.00
11-1212-000-0000-02316-0025 5120 HS.COUN TESTING SUP	1,652.00	.00	.00	800.00	852.00
11-1212-000-0000-02316-0025 5910 HS.COUN OFFICE SUPP	650.00	119.68	.00	546.51	103.49
11-1212-000-0000-02316-0025 6410 HS.COUN NEW EQUIP/F	.00	.00	.00	.00	.00
11-1219-000-0000-02315-0025 1660 EL.NOON SAL SUPVR-I	35,116.00	3,372.20	.00	29,559.73	5,556.27
11-1219-000-0000-02316-0025 1660 HS.NOON SAL SUPVR-I	1,738.50	874.00	.00	6,735.50	-4,997.00
11-1219-000-0000-02315-0025 2820 EL.NOON EMPLOYEE RE	9,172.00	945.55	.00	8,286.70	885.30
11-1219-000-0000-02316-0025 2820 HS.NOON EMPLOYEE RE	435.00	229.04	.00	1,760.78	-1,325.78
11-1219-000-0000-02315-0025 2830 EL.NOON EMPLOYER SO	2,686.00	254.44	.00	2,231.18	454.82
11-1219-000-0000-02316-0025 2830 HS.NOON EMPLOYER SO	133.00	62.41	.00	473.90	-340.90
11-1221-000-0000-02315-0025 5110 EL.INSER TEACHING S	.00	.00	.00	.00	.00
11-1221-000-0000-02316-0025 5110 HS.INSER TEACHING S	.00	.00	.00	.00	.00
TOTAL DEPARTMENT - SUPPORT SERVICES PUPIL	281,697.45	24,697.71	.00	181,614.28	100,083.17
11-1222-000-0000-02316-0026 1230 HS.LIB SALARY LIBRA	.00	.00	.00	.00	.00



SPI  
 DATE: 03/15/2019  
 TIME: 12:03:09

MADISON SCHOOL DISTRICT  
 DETAIL EXPENDITURE STATUS REPORT

PAGE NUMBER: 10  
 EXPSTA11

SELECTION CRITERIA: orgn.fund='11'  
 ACCOUNTING PERIOD: 8/19

SORTED BY: FUND,DEPARTMENT,FUNCTION,ACCOUNT  
 TOTALED ON: FUND,DEPARTMENT  
 PAGE BREAKS ON: FUND

FUND - 11 - GENERAL FUND

ORGANIZATION / ACCOUNT / TITLE	BUDGET	PERIOD EXPENDITURES	ENCUMBRANCES OUTSTANDING	YEAR TO DATE EXP	AVAILABLE BALANCE
11-1222-000-0000-02315-0026 1630 EL.LIB SALARY AIDE	16,022.98	1,579.92	.00	10,390.92	5,632.06
11-1222-000-0000-02316-0026 1630 HS.LIB SALARY AIDE	21,693.75	1,823.19	.00	14,596.45	7,097.30
11-1222-000-0000-02315-0026 2130 EL.LIB EMPLOYEE INS	.00	.00	.00	.00	.00
11-1222-000-0000-02316-0026 2130 HS.LIB EMPLOYEE INS	.00	-750.00	.00	.00	.00
11-1222-000-0000-02316-0026 2210 HS.LIB EARLY RETIRE	.00	.00	.00	.00	.00
11-1222-000-0000-02315-0026 2820 EL.LIB EMPLOYEE RET	4,237.88	460.35	.00	3,047.00	1,190.88
11-1222-000-0000-02316-0026 2820 HS.LIB EMPLOYEE RET	6,499.45	455.07	.00	4,282.04	2,217.41
11-1222-000-0000-02316-0026 2821 HS.LIB RETIREMT STU	7,919.01	467.57	.00	2,337.84	5,581.17
11-1222-000-0000-02315-0026 2830 EL.LIB EMPLOYER SOC	1,225.76	120.86	.00	794.86	430.90
11-1222-000-0000-02316-0026 2830 HS.LIB EMPLOYER SOC	2,011.97	139.48	.00	1,304.92	707.05
11-1222-000-0000-02316-0026 2920 HS.LIB CASH IN LIEU	4,606.50	.00	.00	2,460.25	2,146.25
11-1222-000-0000-02315-0026 3220 EL.LIB WKSHOPS/CONF	.00	.00	.00	.00	.00
11-1222-000-0000-02316-0026 3220 HS.LIB WKSHOPS/CONF	.00	.00	.00	.00	.00
11-1222-000-0000-02315-0026 4120 EL.LIB REPAIRS EQUI	.00	.00	.00	.00	.00
11-1222-000-0000-02316-0026 4120 HS.LIB REPAIRS EQUI	.00	.00	.00	.00	.00
11-1222-000-0000-02315-0026 5310 EL.LIB LIBRARY BOOK	530.00	46.96	.00	46.96	483.04
11-1222-000-0000-02316-0026 5310 HS.LIB LIBRARY BOOK	.00	.00	.00	1,171.07	-1,171.07
11-1222-000-0000-02315-0026 5990 EL.LIB MISC. SUPPLI	1,400.00	.00	43.13	1,063.12	293.75
11-1222-000-0000-02316-0026 5990 HS.LIB MISC. SUPPLI	.00	.00	.00	.00	.00
11-1222-000-0000-02315-0026 6410 EL.LIB NEW EQUIP/FU	500.00	.00	.00	.00	500.00
11-1222-000-0000-02316-0026 6410 HS.LIB NEW EQUIP/FU	350.00	.00	.00	50.94	299.06
11-1222-000-0000-02316-0026 8220 HS.LIB PAYMT TO ANO	.00	.00	.00	34.25	-34.25
TOTAL DEPARTMENT - LIBRARY	66,997.30	4,343.40	43.13	41,580.62	25,373.55
11-1293-000-0000-02316-0027 1560 ATHLETIC COACH SALA	155,194.82	8,200.88	.00	91,000.50	64,194.32
11-1293-000-0000-02316-0027 2130 ATHLETIC EMPLOYEE I	5,000.00	.00	.00	1,964.57	3,035.43
11-1293-000-0000-02316-0027 2820 ATHLETIC EMPLOYEE R	41,347.80	2,145.53	.00	24,212.90	17,134.90
11-1293-000-0000-02316-0027 2821 ATHLETIC RETIREMT S	18,823.89	1,924.64	.00	9,623.19	9,200.70
11-1293-000-0000-02316-0027 2830 ATHLETIC EMPLOYER S	11,872.40	585.64	.00	6,522.99	5,349.41
11-1293-000-0000-02316-0027 3110 ATHLETIC PURCHASED	87,481.00	12,385.39	.00	37,435.14	50,045.86
11-1293-000-0000-02316-0027 3220 ATHLETIC WKSHOPS/CO	.00	.00	.00	.00	.00
11-1293-000-0000-02316-0027 5990 ATHLETIC MISC. SUPP	66,000.00	343.24	132.96	1,004.99	64,862.05
11-1293-000-0000-02316-0027 6410 ATHLETIC NEW EQUIP/	3,000.00	.00	.00	.00	3,000.00
11-1293-000-0000-02316-0027 6420 ATHLETIC FURN/EQUIP	.00	.00	.00	.00	.00
11-1293-000-0000-02316-0027 7410 ATHLETIC DUES/FEES	.00	.00	.00	.00	.00
TOTAL DEPARTMENT - ATHLETIC	388,719.91	25,585.32	132.96	171,764.28	216,822.67
11-1231-000-0000-00000-0028 3180 BUSINESS OFFICE AUD	13,000.00	.00	.00	21,710.00	-8,710.00
11-1232-000-0000-00000-0028 1110 SUPER SALARY SUPERI	111,505.80	8,500.44	.00	72,253.74	39,252.06
11-1232-000-0000-00000-0028 1390 SUPER SALARY-ADMIN.	41,944.00	3,172.60	.00	26,967.10	14,976.90
11-1232-000-0000-00000-0028 1490 SUPER STAKEHOLDER	7,231.25	607.72	.00	4,815.48	2,415.77
11-1232-000-0000-00000-0028 1620 SUPER SALARY-SECR	71,013.90	5,589.66	.00	42,428.79	28,585.11
11-1232-000-0000-00000-0028 1999 SUPER MISC	.00	.00	.00	-5.00	5.00
11-1232-000-0000-00000-0028 2130 SUPER EMPLOYEE INSU	103,559.60	16,085.72	.00	73,677.11	29,882.49

SPI  
 DATE: 03/15/2019  
 TIME: 12:03:09

MADISON SCHOOL DISTRICT  
 DETAIL EXPENDITURE STATUS REPORT

PAGE NUMBER: 11  
 EXPSTALL

SELECTION CRITERIA: orgn.fund='11'  
 ACCOUNTING PERIOD: 8/19

SORTED BY: FUND,DEPARTMENT,FUNCTION,ACCOUNT  
 TOTALED ON: FUND,DEPARTMENT  
 PAGE BREAKS ON: FUND

FUND - 11 - GENERAL FUND

ORGANIZATION / ACCOUNT / TITLE	BUDGET	PERIOD EXPENDITURES	ENCUMBRANCES OUTSTANDING	YEAR TO DATE EXP	AVAILABLE BALANCE
11-1232-000-0000-00000-0028 2820 SUPER EMPLOYEE RETI	113,710.10	4,530.06	.00	37,018.24	76,691.86
11-1232-000-0000-00000-0028 2821 SUPER RETIREMT STUD	63,611.75	5,502.06	.00	27,510.32	36,101.43
11-1232-000-0000-00000-0028 2830 SUPER EMPLOYER SOCI	35,033.89	1,315.21	.00	9,727.41	25,306.48
11-1232-000-0000-00000-0028 2920 SUPER CASH IN LIEU	8,201.25	353.26	.00	3,822.75	4,378.50
11-1232-000-0000-00000-0028 2990 SUPER SICK DAY REIM	1,763.00	.00	.00	.00	1,763.00
11-1232-000-0000-00000-0028 3170 SUPER LEGAL SERVICE	8,000.00	29.47	.00	8,962.17	-962.17
11-1232-000-0000-00000-0028 3190 SUPER UNEMPLOYMENT	2,880.00	.00	.00	2,160.00	720.00
11-1232-000-0000-00000-0028 3191 SUPER BOARD EXPENSE	2,900.00	.00	.00	2,900.00	.00
11-1232-000-0000-00000-0028 3220 SUPER WKSHOPS/CONF	5,000.00	227.81	.00	5,949.18	-949.18
11-1232-000-0000-00000-0028 3450 SUPER SOFTWARE	1,000.00	22.78	.00	1,509.76	-509.76
11-1232-000-0000-00000-0028 4190 SUPER TECH REPAIRS	.00	.00	.00	.00	.00
11-1232-000-0000-00000-0028 4220 SUPER RENTALS EQUIP	3,400.00	.00	.00	2,071.54	1,328.46
11-1232-000-0000-00000-0028 4910 SUPER SALARY ELECTI	.00	.00	.00	.00	.00
11-1232-000-0000-00000-0028 5910 SUPER OFFICE SUPPLI	2,500.00	359.11	49.85	2,679.36	-229.21
11-1232-000-0000-00000-0028 5990 SUPER MISC. SUPPLIE	3,000.00	-55.03	12.98	1,467.55	1,519.47
11-1232-000-0000-00000-0028 5997 SUPER TECH SUPPLIES	400.00	11.49	.00	191.78	208.22
11-1232-000-0000-00000-0028 6410 SUPER NEW EQUIP/FUR	500.00	.00	.00	219.99	280.01
11-1232-000-0000-00000-0028 6427 SUPER TECH EQUIPMEN	1,700.00	22.55	-22.55	20,531.39	-18,808.84
11-1232-000-0000-00000-0028 7410 SUPER DUES/FEES	9,590.00	4,449.00	.00	15,907.88	-6,317.88
11-1232-000-0000-00000-0028 8220 SUPER PAYMT TO ANOT	2,600.00	.00	.00	2,575.73	24.27
11-1252-000-0000-00000-0028 1310 ACCT SALARY-ACCOUNT	146,174.20	11,144.20	.00	94,725.70	51,448.50
11-1252-000-0000-00000-0028 2820 ACCT EMPLOYEE RETIR	.00	2,857.16	.00	24,082.78	-24,082.78
11-1252-000-0000-00000-0028 2830 ACCT EMPLOYER SOCIA	.00	821.54	.00	6,547.87	-6,547.87
11-1252-000-0000-00000-0028 2920 ACCT CASH IN LIEU O	.00	151.40	.00	1,286.90	-1,286.90
11-1257-000-0000-00000-0028 3610 PRINT PRINTING/BIND	8,000.00	.00	.00	1,237.32	6,762.68
11-1259-000-0000-00000-0028 7210 BUSINESS INTEREST S	.00	.00	.00	.00	.00
11-1259-000-0000-00000-0028 7410 BUSINESS DUES/FEES	12,000.00	231.89	.00	2,890.57	9,109.43
11-1259-000-0000-00000-0028 7610 BUSINESS TAXES ABAT	.00	.00	.00	18,930.09	-18,930.09
11-1289-000-0000-00000-0028 1590 TECH SALARY OTHER T	69,112.90	4,963.54	.00	43,280.90	25,832.00
11-1289-000-0000-00000-0028 2820 TECH EMPLOYEE RETIR	.00	1,300.62	.00	10,920.42	-10,920.42
11-1289-000-0000-00000-0028 2830 TECH EMPLOYER SOCIA	.00	345.32	.00	3,055.31	-3,055.31
11-1289-000-0000-00000-0028 2990 TECH SICK DAY REIMB	1,013.00	.00	.00	.00	1,013.00
11-1289-000-0000-00000-0028 3450 TECH SOFTWARE	1,000.00	.00	.00	3,660.94	-2,660.94
11-1289-000-0000-00000-0028 4190 TECH TECH REPAIRS	550.00	.00	.00	.00	550.00
11-1289-000-0000-00000-0028 5997 TECH TECH SUPPLIES	900.00	.00	.00	210.45	689.55
11-1289-000-0000-00000-0028 6427 TECH TECH EQUIPMENT	2,000.00	204.99	.00	2,680.32	-680.32
11-1511-000-0000-00000-0028 7140 DEBT REDEMPTION BON	102,000.00	.00	.00	102,000.00	.00
11-1511-000-0000-00000-0028 7240 DEBT INTEREST ON BO	45,508.93	.00	.00	14,685.34	30,823.59
TOTAL DEPARTMENT - GENERAL ADMIN/BUSINESS	1,002,303.57	72,744.57	40.28	717,247.18	285,016.11
11-1241-000-0000-02315-0029 1150 EL.PRIN SALARY SCH.	131,026.78	10,025.56	.00	85,217.26	45,809.52
11-1241-000-0000-02316-0029 1150 HS.PRIN SALARY SCH.	173,414.20	13,179.56	.00	112,026.26	61,387.94
11-1241-000-0000-07262-0029 1150 MS.PRIN SALARY SCH.	172,049.67	13,105.74	.00	111,398.79	60,650.88
11-1241-000-0000-02315-0029 1620 EL.PRIN SALARY-SECR	55,116.14	4,970.87	.00	29,015.94	26,100.20
11-1241-000-0000-02316-0029 1620 HS.PRIN SALARY-SECR	42,486.00	3,268.18	.00	21,243.17	21,242.83

SPI  
 DATE: 03/15/2019  
 TIME: 12:03:09

MADISON SCHOOL DISTRICT  
 DETAIL EXPENDITURE STATUS REPORT

PAGE NUMBER: 12  
 EXPSTA11

SELECTION CRITERIA: orgn.fund='11'  
 ACCOUNTING PERIOD: 8/19

SORTED BY: FUND,DEPARTMENT,FUNCTION,ACCOUNT  
 TOTALED ON: FUND,DEPARTMENT  
 PAGE BREAKS ON: FUND

FUND - 11 - GENERAL FUND

ORGANIZATION / ACCOUNT / TITLE	BUDGET	PERIOD EXPENDITURES	ENCUMBRANCES OUTSTANDING	YEAR TO DATE EXP	AVAILABLE BALANCE
11-1241-000-0000-07262-0029 1620 MS.PRIN SALARY-SECR	30,575.00	2,390.25	.00	16,012.32	14,562.68
11-1241-000-0000-02315-0029 2130 EL.PRIN EMPLOYEE IN	24,506.22	4,764.02	.00	18,827.39	5,678.83
11-1241-000-0000-02316-0029 2130 HS.PRIN EMPLOYEE IN	17,545.06	2,681.44	.00	13,504.80	4,040.26
11-1241-000-0000-07262-0029 2130 MS.PRIN EMPLOYEE IN	42,449.83	5,868.00	.00	24,025.42	18,424.41
11-1241-000-0000-02315-0029 2210 EL.PRIN EARLY RETIR	.00	.00	.00	.00	.00
11-1241-000-0000-02316-0029 2210 HS.PRIN EARLY RETIR	.00	.00	.00	.00	.00
11-1241-000-0000-02315-0029 2820 EL.PRIN EMPLOYEE RE	49,329.72	3,815.24	.00	30,035.41	19,294.31
11-1241-000-0000-02316-0029 2820 HS.PRIN EMPLOYEE RE	55,163.64	4,306.00	.00	34,624.43	20,539.21
11-1241-000-0000-07262-0029 2820 MS.PRIN EMPLOYEE RE	51,890.87	4,058.30	.00	33,011.44	18,879.43
11-1241-000-0000-02315-0029 2821 EL.PRIN RETIREMT ST	26,353.44	2,261.72	.00	11,308.60	15,044.84
11-1241-000-0000-02316-0029 2821 HS.PRIN RETIREMT ST	32,454.98	2,653.17	.00	13,265.85	19,189.13
11-1241-000-0000-07262-0029 2821 MS.PRIN RETIREMT ST	30,637.50	2,566.18	.00	12,830.90	17,806.60
11-1241-000-0000-02315-0029 2830 EL.PRIN EMPLOYER SO	14,959.64	1,186.18	.00	8,917.43	6,042.21
11-1241-000-0000-02316-0029 2830 HS.PRIN EMPLOYER SO	17,640.30	1,253.64	.00	10,068.37	7,571.93
11-1241-000-0000-07262-0029 2830 MS.PRIN EMPLOYER SO	16,186.30	1,156.92	.00	9,427.43	6,758.87
11-1241-000-0000-02315-0029 2840 EL.PRIN WORKMANS CO	120.00	.00	.00	120.00	.00
11-1241-000-0000-02316-0029 2840 HS.PRIN WORKMANS CO	120.00	.00	.00	120.00	.00
11-1241-000-0000-07262-0029 2840 MS.PRIN WORKMANS CO	.00	.00	.00	.00	.00
11-1241-000-0000-02315-0029 2850 EL.PRIN UNEMPLOYMEN	.00	.00	.00	.00	.00
11-1241-000-0000-07262-0029 2850 MS.PRIN UNEMPLOYMEN	.00	.00	.00	.00	.00
11-1241-000-0000-02315-0029 2920 EL.PRIN CASH IN LIE	7,741.98	1,100.16	.00	7,332.72	409.26
11-1241-000-0000-02316-0029 2920 HS.PRIN CASH IN LIE	13,122.00	1,009.32	.00	7,569.90	5,552.10
11-1241-000-0000-07262-0029 2920 MS.PRIN CASH IN LIE	6,561.00	504.66	.00	3,280.29	3,280.71
11-1241-000-0000-02315-0029 2990 EL.PRIN SICK DAY RE	1,688.00	.00	.00	.00	1,688.00
11-1241-000-0000-02316-0029 2990 HS.PRIN SICK DAY RE	1,650.00	.00	.00	.00	1,650.00
11-1241-000-0000-07262-0029 2990 MS.PRIN SICK DAY RE	2,400.00	.00	.00	.00	2,400.00
11-1241-000-0000-02315-0029 3220 EL.PRIN WKSHOPS/CON	.00	35.00	.00	3,828.92	-3,828.92
11-1241-000-0000-02316-0029 3220 HS.PRIN WKSHOPS/CON	500.00	.00	.00	-141.94	641.94
11-1241-000-0000-07262-0029 3220 MS.PRIN WKSHOPS/CON	.00	.00	.00	604.51	-604.51
11-1241-000-0000-02315-0029 4120 EL.PRIN REPAIRS EQU	.00	.00	.00	105.00	-105.00
11-1241-000-0000-02316-0029 4120 HS.PRIN REPAIRS EQU	.00	.00	.00	.00	.00
11-1241-000-0000-07262-0029 4120 MS.PRIN REPAIRS EQU	.00	.00	.00	.00	.00
11-1241-000-0000-02315-0029 5910 EL.PRIN OFFICE SUPP	2,500.00	261.10	.00	4,107.05	-1,607.05
11-1241-000-0000-02316-0029 5910 HS.PRIN OFFICE SUPP	1,200.00	550.00	.00	2,265.73	-1,065.73
11-1241-000-0000-07262-0029 5910 MS.PRIN OFFICE SUPP	1,700.00	.00	.00	1,782.00	-82.00
11-1241-000-0000-02315-0029 5990 EL.PRIN MISC. SUPPL	3,500.00	.00	.00	1,755.14	1,744.86
11-1241-000-0000-02316-0029 5990 HS.PRIN MISC. SUPPL	1,000.00	.00	.00	305.76	694.24
11-1241-000-0000-07262-0029 5990 MS.PRIN MISC. SUPPL	1,000.00	.00	.00	267.67	732.33
11-1241-000-0000-02315-0029 6410 EL.PRIN NEW EQUIP/F	300.00	.00	.00	1,881.62	-1,581.62
11-1241-000-0000-02316-0029 6410 HS.PRIN NEW EQUIP/F	110.00	.00	.00	.00	110.00
11-1241-000-0000-07262-0029 6410 MS.PRIN NEW EQUIP/F	200.00	260.00	219.99	260.00	-279.99
11-1241-000-0000-02315-0029 7410 EL.PRIN DUES/FEES	.00	.00	.00	1,190.00	-1,190.00
11-1241-000-0000-02316-0029 7410 HS.PRIN DUES/FEES	.00	.00	.00	800.00	-800.00
11-1241-000-0000-07262-0029 7410 MS.PRIN DUES/FEES	.00	.00	.00	.00	.00
TOTAL DEPARTMENT - SCHOOL ADMIN - PRINCIPAL	1,029,198.27	87,231.21	219.99	632,195.58	396,782.70

SPI  
 DATE: 03/15/2019  
 TIME: 12:03:09

MADISON SCHOOL DISTRICT  
 DETAIL EXPENDITURE STATUS REPORT

PAGE NUMBER: 13  
 EXPSTALL

SELECTION CRITERIA: orgn.fund='11'  
 ACCOUNTING PERIOD: 8/19

SORTED BY: FUND,DEPARTMENT,FUNCTION,ACCOUNT  
 TOTALED ON: FUND,DEPARTMENT  
 PAGE BREAKS ON: FUND

FUND - 11 - GENERAL FUND

ORGANIZATION / ACCOUNT / TITLE	BUDGET	PERIOD EXPENDITURES	ENCUMBRANCES OUTSTANDING	YEAR TO DATE EXP	AVAILABLE BALANCE
11-1351-000-0822-02315-0030 1630 EL.LATCH SALARY AID	35,559.00	2,525.31	.00	21,633.54	13,925.46
11-1351-000-0822-02315-0030 2820 EL.LATCH EMPLOYEE R	9,754.97	599.18	.00	5,557.67	4,197.30
11-1351-000-0822-02315-0030 2821 EL.LATCH RETIREMT S	4,284.06	413.20	.00	2,066.00	2,218.06
11-1351-000-0822-02315-0030 2830 EL.LATCH EMPLOYER S	2,720.26	191.98	.00	1,645.68	1,074.58
11-1351-000-0822-02315-0030 5110 EL.LATCH TEACHING S	700.00	.00	43.44	515.38	141.18
11-1391-000-0822-02315-0030 1160 EL.PARED SALARY SCH	25,010.00	.00	.00	3,692.50	21,317.50
11-1391-000-0822-02315-0030 2820 EL.PARED EMPLOYEE R	6,136.96	.00	.00	952.92	5,184.04
11-1391-000-0822-02315-0030 2821 EL.PARED RETIREMT S	4,673.52	217.47	.00	1,087.36	3,586.16
11-1391-000-0822-02315-0030 2830 EL.PARED EMPLOYER S	1,836.77	.00	.00	274.01	1,562.76
11-1391-000-0822-02315-0030 3220 EL.PARED WKSHOPS/CO	500.00	.00	.00	147.80	352.20
11-1391-000-0822-02315-0030 5110 EL.PARED TEACHING S	185.00	.00	.00	278.70	-93.70
11-1391-000-0822-02315-0030 6410 EL.PARED NEW EQUIP/	.00	.00	.00	.00	.00
TOTAL DEPARTMENT - COMMUNITY SERVICES	91,360.54	3,947.14	43.44	37,851.56	53,465.54
11-1261-000-0000-00000-0031 1170 OPER SALARY SUPVR-I	35,250.00	2,596.16	.00	22,067.36	13,182.64
11-1261-000-0000-00000-0031 1550 OPER SALARY - MAINT	72,015.60	6,259.20	.00	52,188.41	19,827.19
11-1261-000-0000-00000-0031 1640 OPER SALARY CUSTODI	243,950.36	17,169.94	.00	149,067.08	94,883.28
11-1261-000-0000-00000-0031 1960 OPER OVERTIME OPERA	10,815.39	1,129.02	.00	5,683.85	5,131.54
11-1261-000-0000-00000-0031 2130 OPER EMPLOYEE INSUR	116,957.68	13,727.30	.00	63,814.55	53,143.13
11-1261-000-0000-00000-0031 2820 OPER EMPLOYEE RETIR	94,312.74	7,323.83	.00	60,418.68	33,894.06
11-1261-000-0000-00000-0031 2821 OPER RETIREMT STUDE	54,784.00	4,392.95	.00	21,964.76	32,819.24
11-1261-000-0000-00000-0031 2830 OPER EMPLOYER SOCIA	27,951.42	2,006.40	.00	16,922.01	11,029.41
11-1261-000-0000-00000-0031 2840 OPER WORKMANS COMPE	6,620.00	.00	.00	3,599.00	3,021.00
11-1261-000-0000-00000-0031 2850 OPER UNEMPLOYMENT C	.00	.00	.00	.00	.00
11-1261-000-0000-00000-0031 2920 OPER CASH IN LIEU O	3,280.50	773.02	.00	6,544.62	-3,264.12
11-1261-000-0000-00000-0031 2990 OPER SICK DAY REIMB	2,175.00	.00	.00	.00	2,175.00
11-1261-000-0000-00000-0031 3220 OPER WKSHOPS/CONF I	.00	.00	.00	.00	.00
11-1261-000-0000-00000-0031 3410 OPER TELEPHONE	15,075.00	917.10	.00	7,500.57	7,574.43
11-1261-000-0000-00000-0031 3830 OPER WATER AND SEWA	15,500.00	.00	.00	10,077.29	5,422.71
11-1261-000-0000-00000-0031 3840 OPER WASTE AND TRAS	3,523.59	315.23	.00	2,705.86	817.73
11-1261-000-0000-00000-0031 3910 OPER INSURANCE LIAB	60,691.11	.00	.00	58,517.00	2,174.11
11-1261-000-0000-00000-0031 3911 OPER BOILER INSURAN	4,332.16	.00	.00	4,084.00	248.16
11-1261-000-0000-00000-0031 4110 OPER REPAIRS BLDG/L	2,650.00	350.00	.00	37,187.00	-34,537.00
11-1261-000-0000-00000-0031 4120 OPER REPAIRS EQUIPM	18,300.00	3,311.28	110.00	10,103.58	8,086.42
11-1261-000-0000-00000-0031 4220 OPER RENTALS EQUIP	58,000.00	591.00	.00	10,071.25	47,928.75
11-1261-000-0000-00000-0031 5510 OPER HEATING GAS	75,000.00	11,278.24	.00	29,430.05	45,569.95
11-1261-000-0000-00000-0031 5520 OPER ELECTRICITY	162,000.00	13,563.24	.00	87,594.01	74,405.99
11-1261-000-0000-00000-0031 5910 OPER OFFICE SUPPLIE	1,325.00	.00	.00	97.84	1,227.16
11-1261-000-0000-00000-0031 5980 OPER MAINTENANCE SU	14,000.00	383.36	1,926.00	7,690.56	4,383.44
11-1261-000-0000-00000-0031 5981 OPER BOILER TREATME	.00	.00	.00	.00	.00
11-1261-000-0000-00000-0031 5990 OPER MISC. SUPPLIES	27,000.00	1,141.85	.00	17,748.75	9,251.25
11-1455-000-0000-00000-0031 6220 AQUIS FURN/EQUIP BL	67,000.00	.00	6,634.00	35,778.66	24,587.34
11-1455-000-0000-00000-0031 6221 AQUIS FURN/EQUIP GR	88,920.00	.00	.00	43,519.47	45,400.53
TOTAL DEPARTMENT - OPERATION-MAINTENANCE	1,281,429.55	87,229.12	8,670.00	764,376.21	508,383.34

SPI  
 DATE: 03/15/2019  
 TIME: 12:03:09

MADISON SCHOOL DISTRICT  
 DETAIL EXPENDITURE STATUS REPORT

PAGE NUMBER: 14  
 EXPSTALL

SELECTION CRITERIA: orgn.fund='11'  
 ACCOUNTING PERIOD: 8/19

SORTED BY: FUND,DEPARTMENT,FUNCTION,ACCOUNT  
 TOTALED ON: FUND,DEPARTMENT  
 PAGE BREAKS ON: FUND

FUND - 11 - GENERAL FUND

ORGANIZATION / ACCOUNT / TITLE	BUDGET	PERIOD EXPENDITURES	ENCUMBRANCES OUTSTANDING	YEAR TO DATE EXP	AVAILABLE BALANCE
11-1391-000-0000-02316-0032 1160 PAC SALARY SCH. DIR	5,000.00	500.00	.00	3,250.00	1,750.00
11-1391-000-0000-02316-0032 2130 PAC EMPLOYEE INSURA	.00	.00	.00	.00	.00
11-1391-000-0000-02316-0032 2820 PAC EMPLOYEE RETIRE	1,278.00	130.90	.00	847.75	430.25
11-1391-000-0000-02316-0032 2821 PAC RETIREMT STUDEN	908.74	65.24	.00	326.20	582.54
11-1391-000-0000-02316-0032 2830 PAC EMPLOYER SOCIAL	382.50	37.12	.00	241.28	141.22
11-1391-000-0000-02316-0032 2920 PAC CASH IN LIEU OF	.00	.00	.00	.00	.00
11-1391-000-0000-02316-0032 3110 PAC PURCHASED SERVI	.00	.00	.00	1,910.60	-1,910.60
11-1391-000-0000-02316-0032 5110 PAC TEACHING SUPPLY	200.00	.00	.00	.00	200.00
11-1391-000-0000-02316-0032 5990 PAC MISC. SUPPLIES/	150.00	6.20	.00	6.20	143.80
11-1391-000-0000-02316-0032 6410 PAC NEW EQUIP/FURN	3,900.00	.00	1,708.00	1,006.40	1,185.60
TOTAL DEPARTMENT - PAC	11,819.24	739.46	1,708.00	7,588.43	2,522.81
11-1271-000-0000-00000-0033 1170 TRANS SALARY SUPVR-	34,250.00	2,596.14	.00	22,067.19	12,182.81
11-1271-000-0000-00000-0033 1550 TRANS SALARY - MAIN	10,160.80	.00	.00	.00	10,160.80
11-1271-000-0000-00000-0033 1610 TRANS SALARY VEHICL	129,307.64	13,061.23	.00	91,363.19	37,944.45
11-1271-000-0000-00000-0033 1611 TRANS SALARY-EXTRA	22,270.59	2,085.54	.00	16,324.48	5,946.11
11-1271-000-0000-00000-0033 1620 TRANS SALARY-SECR	1,650.00	.00	.00	.00	1,650.00
11-1271-000-0000-00000-0033 1630 TRANS SALARY AIDE	7,195.50	886.09	.00	9,155.10	-1,959.60
11-1271-000-0000-00000-0033 2130 TRANS EMPLOYEE INSU	771.96	46.76	.00	397.37	374.59
11-1271-000-0000-00000-0033 2820 TRANS EMPLOYEE RETI	54,189.24	5,045.25	.00	37,468.74	16,720.50
11-1271-000-0000-00000-0033 2821 TRANS RETIREMT STUD	31,935.70	2,642.30	.00	13,211.49	18,724.21
11-1271-000-0000-00000-0033 2830 TRANS EMPLOYER SOCI	15,966.86	1,421.77	.00	10,615.73	5,351.13
11-1271-000-0000-00000-0033 2840 TRANS WORKMANS COMP	1,402.00	.00	.00	1,402.00	.00
11-1271-000-0000-00000-0033 2850 TRANS UNEMPLOYMENT	.00	.00	.00	.00	.00
11-1271-000-0000-00000-0033 2920 TRANS CASH IN LIEU	3,280.50	252.32	.00	2,144.72	1,135.78
11-1271-000-0000-00000-0033 2990 TRANS SICK DAY REIM	600.00	.00	.00	.00	600.00
11-1271-000-0000-00000-0033 3192 TRANS PHYSICALS	1,100.00	.00	.00	1,023.00	77.00
11-1271-000-0000-00000-0033 3220 TRANS WKSHOPS/CONF	.00	.00	.00	500.00	-500.00
11-1271-000-0000-00000-0033 3930 TRANS TRANSPORTATIO	8,680.00	.00	.00	9,725.00	-1,045.00
11-1271-000-0000-00000-0033 4130 TRANS BUS MECHANIC	18,000.00	855.00	.00	16,811.45	1,188.55
11-1271-000-0000-00000-0033 4230 TRANS CONTRACTED SE	896.00	.00	.00	537.50	358.50
11-1271-000-0000-00000-0033 5710 TRANS GASOLINE, OIL	33,000.00	2,399.16	.00	22,808.44	10,191.56
11-1271-000-0000-00000-0033 5720 TRANS TIRES,TUBES A	2,505.00	.00	.00	5,863.22	-3,358.22
11-1271-000-0000-00000-0033 5730 TRANS VEHICLE REPAI	25,000.00	1,396.07	.00	21,501.45	3,498.55
11-1271-000-0000-00000-0033 5910 TRANS OFFICE SUPPLI	200.00	.00	.00	.00	200.00
11-1271-000-0000-00000-0033 5990 TRANS MISC. SUPPLIE	600.00	50.00	.00	2,244.79	-1,644.79
11-1271-000-0000-00000-0033 6410 TRANS NEW EQUIP/FUR	.00	.00	.00	.00	.00
11-1271-000-0000-00000-0033 6510 TRANS NEW VEHICLES	.00	.00	.00	.00	.00
11-1271-000-0000-00000-0033 6610 TRANS SCHOOL BUS PU	73,500.00	.00	.00	.00	73,500.00
11-1271-000-0000-00000-0033 7410 TRANS DUES/FEES	500.00	.00	.00	915.91	-415.91
TOTAL DEPARTMENT - TRANSPORTATION	476,961.79	32,737.63	.00	286,080.77	190,881.02

SPI  
DATE: 03/15/2019  
TIME: 12:03:09

MADISON SCHOOL DISTRICT  
DETAIL EXPENDITURE STATUS REPORT

PAGE NUMBER: 15  
EXPSTA11

SELECTION CRITERIA: orgn.fund='11'  
ACCOUNTING PERIOD: 8/19

SORTED BY: FUND,DEPARTMENT,FUNCTION,ACCOUNT  
TOTALLED ON: FUND,DEPARTMENT  
PAGE BREAKS ON: FUND

FUND - 11 - GENERAL FUND

ORGANIZATION / ACCOUNT / TITLE	BUDGET	PERIOD EXPENDITURES	ENCUMBRANCES OUTSTANDING	YEAR TO DATE EXP	AVAILABLE BALANCE
11-1621-000-0000-00000-0040 8110 MODFUND ATHLETIC	.00	.00	.00	.00	.00
11-1633-000-0000-00000-0040 8110 MODFUND DEBT ATHLET	.00	.00	.00	.00	.00
11-1641-000-0000-00000-0040 8110 MODFUND B&S ATHLETI	.00	.00	.00	.00	.00
TOTAL DEPARTMENT - MODICATIONS	.00	.00	.00	.00	.00
TOTAL FUND - GENERAL FUND	17,315,799.10	1,307,034.93	16,326.78	9,618,371.88	7,681,100.44
TOTAL REPORT	17,315,799.10	1,307,034.93	16,326.78	9,618,371.88	7,681,100.44

SPI  
 DATE: 03/14/2019  
 TIME: 13:57:36

MADISON SCHOOL DISTRICT  
 CHECK REGISTER

PAGE NUMBER: 1  
 VENCHK11  
 ACCOUNTING PERIOD: 9/19

FUND - 11 - GENERAL FUND

CHECK NUMBER	CASH ACCT	DATE ISSUED	-----VENDOR-----	ACCT	-----DESCRIPTION-----	AMOUNT
30117	9101	03/18/19	ADRIAN MECHANICAL SERVICE	4120	UNITS 20 & 36	3,311.28
30118	9101	03/18/19	ALL AMERICAN SEWER & DRAI	4110	SEWER SERVICES	350.00
30119	9101	03/18/19	AMAZON CAPITAL SERVICES I	3130	ACCU-CHEK AVIVA PLUS TEST	23.23
30119	9101	03/18/19	AMAZON CAPITAL SERVICES I	5990	CRAMER FELT HORSESHOE PAD	18.00
30119	9101	03/18/19	AMAZON CAPITAL SERVICES I	3130	LICB CR2032 3V LITHIUM BA	1.74
30119	9101	03/18/19	AMAZON CAPITAL SERVICES I	3130	LICB CR2032 3V LITHIUM BA	1.75
30119	9101	03/18/19	AMAZON CAPITAL SERVICES I	3130	LICB CR2032 3V LITHIUM BA	3.50
30119	9101	03/18/19	AMAZON CAPITAL SERVICES I	5990	TAYLOR PRECISION 8215N 8-	9.99
30119	9101	03/18/19	AMAZON CAPITAL SERVICES I	6422	CHILD SAFETY MAGNETIC CAB	47.98
30119	9101	03/18/19	AMAZON CAPITAL SERVICES I	5122	TANGLE SET OF 3 JR. ORIGI	12.20
30119	9101	03/18/19	AMAZON CAPITAL SERVICES I	5121	WELIKERA-CORDLESS-HANDHEL	49.90
30119	9101	03/18/19	AMAZON CAPITAL SERVICES I	5990	30801 BAG ICE PLASTIC 18X	96.39
30119	9101	03/18/19	AMAZON CAPITAL SERVICES I	5990	CRYOCUP - SET OF TWO	14.00
30119	9101	03/18/19	AMAZON CAPITAL SERVICES I	5990	J&J ELASTIKON TAPES 2", 6	48.30
30119	9101	03/18/19	AMAZON CAPITAL SERVICES I	5990	MUELLER ICE BAG DISPENSER	34.49
			TOTAL CHECK			361.47
30120	9101	03/18/19	AMERICAN OFFICE SOLUTIONS	4220	C1851 HS COPIER	1.77
30120	9101	03/18/19	AMERICAN OFFICE SOLUTIONS	4220	C1851 HS COPIER	86.93
			TOTAL CHECK			88.70
30121	9101	03/18/19	ARTHUR L BUDD	5990	UNIFORM ALLOW 18.19	52.59
30122	9101	03/18/19	ATHLETICO MANAGEMENT LLC	3110	ATH TRAINER SERV.	8,360.00
30123	9101	03/18/19	AUTO VALUE ADRIAN	5980	PRIME, CIRCUIT, PWR	151.73
30123	9101	03/18/19	AUTO VALUE ADRIAN	5980	OIL, POWER STEER, SEN	54.02
30123	9101	03/18/19	AUTO VALUE ADRIAN	5980	MOLD, CLAMP	19.65
			TOTAL CHECK			225.40
30124	9101	03/18/19	BATTERY WHOLESALE	5990	TROJAN 6V CORE	161.49
30124	9101	03/18/19	BATTERY WHOLESALE	5990	TROJAN 6V CORE	161.49
			TOTAL CHECK			322.98
30125	9101	03/18/19	CCI SOUTH, INC	6410	ADMIN ASSIST PHONE	260.00
30126	9101	03/18/19	CDW GOVERNMENT, INC.	5997	1192712 - ELELP42 PROJECT	297.00
30126	9101	03/18/19	CDW GOVERNMENT, INC.	6427	3034322 - SANDISK FLASH D	86.60
30126	9101	03/18/19	CDW GOVERNMENT, INC.	6427	4010098 - DOCUMENT CAMERA	499.00
30126	9101	03/18/19	CDW GOVERNMENT, INC.	6427	4634377 - EXTERNAL BURNER	118.39
30126	9101	03/18/19	CDW GOVERNMENT, INC.	3450	HPE CARE PACKS FOR SERVER	22.78
30126	9101	03/18/19	CDW GOVERNMENT, INC.	3450	HPE CARE PACKS FOR SERVER	307.51
30126	9101	03/18/19	CDW GOVERNMENT, INC.	3450	HPE CARE PACKS FOR SERVER	364.46
30126	9101	03/18/19	CDW GOVERNMENT, INC.	3450	HPE CARE PACKS FOR SERVER	444.19
30126	9101	03/18/19	CDW GOVERNMENT, INC.	6427	43201830 - SERVER DRIVES	22.55
30126	9101	03/18/19	CDW GOVERNMENT, INC.	6427	43201830 - SERVER DRIVES	304.33
30126	9101	03/18/19	CDW GOVERNMENT, INC.	6427	43201830 - SERVER DRIVES	360.69
30126	9101	03/18/19	CDW GOVERNMENT, INC.	6427	43201830 - SERVER DRIVES	439.59
			TOTAL CHECK			3,267.09
30127	9101	03/18/19	CENTER MEDICAL SUPPLY	5990	6815472 PRE-WRAP FOAM 2.7	49.95
30127	9101	03/18/19	CENTER MEDICAL SUPPLY	5990	6819086 MOLESKIN 9" X 4 Y	14.95
30127	9101	03/18/19	CENTER MEDICAL SUPPLY	5990	DYN1303 TOWELETTES BZK AN	3.90
30127	9101	03/18/19	CENTER MEDICAL SUPPLY	5990	ESTIMATED SHIPPING/HANDLI	10.43

SPI  
 DATE: 03/14/2019  
 TIME: 13:57:36

MADISON SCHOOL DISTRICT  
 CHECK REGISTER

PAGE NUMBER: 2  
 VENCHK11  
 ACCOUNTING PERIOD: 9/19

FUND - 11 - GENERAL FUND

CHECK NUMBER	CASH ACCT	DATE ISSUED	VENDOR	ACCT	DESCRIPTION	AMOUNT
30127	9101	03/18/19	18892 CENTER MEDICAL SUPPLY	3130	DIA5031-750 PROBE COVERS	9.95
30127	9101	03/18/19	18892 CENTER MEDICAL SUPPLY	3130	ESTIMATED SHIPPING/HANDLI	2.00
TOTAL CHECK						91.18
30128	9101	03/18/19	19180 CENTRAL MICHIGAN PAPER	5110	BMP8511 8.5 X 11 COPY PAP	1,776.00
30128	9101	03/18/19	19180 CENTRAL MICHIGAN PAPER	5110	BMP8511 8.5 X 11 COPY PAP	1,776.00
30128	9101	03/18/19	19180 CENTRAL MICHIGAN PAPER	5110	BMP8511 8.5 X 11 COPY PAP	3,552.00
TOTAL CHECK						7,104.00
30129	9101	03/18/19	20503 CIVIL AIR PATROL/ AE	5121	AEM APP B DIETRICH	35.00
30130	9101	03/18/19	22468 CONSUMERS ENERGY	5520	ELECTRIC	320.21
30130	9101	03/18/19	22468 CONSUMERS ENERGY	5520	ELECTRIC	157.77
30130	9101	03/18/19	22468 CONSUMERS ENERGY	5520	ELECTRIC	57.39
30130	9101	03/18/19	22468 CONSUMERS ENERGY	5520	ELECTRIC	12.55
TOTAL CHECK						547.92
30131	9101	03/18/19	26105 DAVE HEATON	5990	UNIFORM ALLOW 18.19	8.77
30131	9101	03/18/19	26105 DAVE HEATON	5990	UNIFORM ALLOW 18.19	2.00
30131	9101	03/18/19	26105 DAVE HEATON	5990	UNIFORM ALLOW 18.19	60.00
TOTAL CHECK						70.77
30132	9101	03/18/19	29356 DUSSEAU AUTO PARTS	5730	TAIL LITE	50.00
30133	9101	03/18/19	35580 FRAME'S PEST CONTROL, INC	4220	MONTHLY PEST CONTROL	57.00
30134	9101	03/18/19	41491 H & H REPAIR	5730	BUS #8 HAZMAT	18.00
30134	9101	03/18/19	41491 H & H REPAIR	4130	BUS #8 LABOR	472.50
30134	9101	03/18/19	41491 H & H REPAIR	5730	BUS #8 PARTS	554.75
30134	9101	03/18/19	41491 H & H REPAIR	4130	UNIT #4 LABOR	382.50
30134	9101	03/18/19	41491 H & H REPAIR	5730	UNIT #4 PARTS	99.53
30134	9101	03/18/19	41491 H & H REPAIR	5730	UNIT #4 PARTS	3.00
TOTAL CHECK						1,530.28
30135	9101	03/18/19	45140 HOEKSTRA TRUCK EQUIPMENT	5730	BLOCK HEATER, TANK	335.96
30135	9101	03/18/19	45140 HOEKSTRA TRUCK EQUIPMENT	5730	HEATER BLOCK	119.55
TOTAL CHECK						455.51
30136	9101	03/18/19	47396 IMPREST FUND	3220	E MCDONALD CONF	227.81
30136	9101	03/18/19	47396 IMPREST FUND	7410	FINGERPRINTS	63.00
30136	9101	03/18/19	47396 IMPREST FUND	5110	L HOOKER NO PO	30.00
30136	9101	03/18/19	47396 IMPREST FUND	7410	PEDESTRIAN EASEMENT	30.00
30136	9101	03/18/19	47396 IMPREST FUND	5110	PLAY FUNDS/RESOURCES	225.00
30136	9101	03/18/19	47396 IMPREST FUND	5110	S JACKLER SUPPLIES	80.00
TOTAL CHECK						655.81
30137	9101	03/18/19	51053 KATHY JACOBS	5990	PRE-TRIP TRAINING	50.00
30138	9101	03/18/19	55432 LENAWEE INTERMEDIATE SCHO	5910	YEAR END TAX FORMS	72.30
30138	9101	03/18/19	55432 LENAWEE INTERMEDIATE SCHO	3220	AMILLER CPI TRAIN	35.00
30138	9101	03/18/19	55432 LENAWEE INTERMEDIATE SCHO	3221	CLOBKOVICH CPI TRAIN	35.00
TOTAL CHECK						142.30
30139	9101	03/18/19	60890 MARSHALL 'S	6450	INSTRUMENT REPAIR	85.00
30139	9101	03/18/19	60890 MARSHALL 'S	6450	INSTRUMENT REPAIR	223.00
30139	9101	03/18/19	60890 MARSHALL 'S	6450	INSTRUMENT REPAIR	118.00



SPI  
 DATE: 03/14/2019  
 TIME: 13:57:36

MADISON SCHOOL DISTRICT  
 CHECK REGISTER

PAGE NUMBER: 3  
 VENCHK11  
 ACCOUNTING PERIOD: 9/19

FUND - 11 - GENERAL FUND

CHECK NUMBER	CASH ACCT	DATE ISSUED	VENDOR	ACCT	DESCRIPTION	AMOUNT
30139	9101	03/18/19	MARSHALL'S	6450	INSTRUMENT REPAIR	182.00
30139	9101	03/18/19	MARSHALL'S	6450	INSTRUMENT REPAIR	10.00
30139	9101	03/18/19	MARSHALL'S	6450	INSTRUMENT REPAIR	9.00
30139	9101	03/18/19	MARSHALL'S	6450	FLUTE PLUGS	4.89
30139	9101	03/18/19	MARSHALL'S	6450	REEDS	28.99
30139	9101	03/18/19	MARSHALL'S	6450	REEDS	28.99
30139	9101	03/18/19	MARSHALL'S	6450	REEDS	13.99
30139	9101	03/18/19	MARSHALL'S	6450	REEDS	14.00
TOTAL CHECK						717.86
30140	9101	03/18/19	MT BUSINESS TECHNOLOGIES,	4220	U2350 EL OFFICE COPY	3.18
30140	9101	03/18/19	MT BUSINESS TECHNOLOGIES,	4220	U2350 EL OFFICE COPY	156.01
30140	9101	03/18/19	MT BUSINESS TECHNOLOGIES,	4220	Y8850 HS OFFICE COPY	307.05
30140	9101	03/18/19	MT BUSINESS TECHNOLOGIES,	4220	Y8850 HS OFFICE COPY	6.27
30140	9101	03/18/19	MT BUSINESS TECHNOLOGIES,	4220	Z5880 K WING COPIER	2.34
30140	9101	03/18/19	MT BUSINESS TECHNOLOGIES,	4220	Z5880 K WING COPIER	114.47
30140	9101	03/18/19	MT BUSINESS TECHNOLOGIES,	4220	W8440 HS ROOM 122	96.06
30140	9101	03/18/19	MT BUSINESS TECHNOLOGIES,	4220	W8440 HS ROOM 122	1.96
30140	9101	03/18/19	MT BUSINESS TECHNOLOGIES,	4220	Y8788 EL COPIER	145.91
30140	9101	03/18/19	MT BUSINESS TECHNOLOGIES,	4220	Y8788 EL COPIER	2.98
30140	9101	03/18/19	MT BUSINESS TECHNOLOGIES,	5997	Z3042 EL STEM LAB	.02
30140	9101	03/18/19	MT BUSINESS TECHNOLOGIES,	5997	Z3043 MS 10	1.08
30140	9101	03/18/19	MT BUSINESS TECHNOLOGIES,	5997	Z3044 MS LAB 15	22.62
30140	9101	03/18/19	MT BUSINESS TECHNOLOGIES,	5997	Z3045 MS OFFICE	13.95
30140	9101	03/18/19	MT BUSINESS TECHNOLOGIES,	5997	Z3046 MEDIA CENTER	12.88
30140	9101	03/18/19	MT BUSINESS TECHNOLOGIES,	5997	Z3046 MEDIA CENTER	12.89
30140	9101	03/18/19	MT BUSINESS TECHNOLOGIES,	5997	Z3047 CENTRAL OFFICE	11.49
30140	9101	03/18/19	MT BUSINESS TECHNOLOGIES,	5997	Z3048 HS COUNSELING	15.09
30140	9101	03/18/19	MT BUSINESS TECHNOLOGIES,	5997	Z3049 HS OFFICE	21.42
30140	9101	03/18/19	MT BUSINESS TECHNOLOGIES,	5997	Z3050 HS CART 2	4.64
30140	9101	03/18/19	MT BUSINESS TECHNOLOGIES,	5997	Z3051 HS LAB 113	3.18
30140	9101	03/18/19	MT BUSINESS TECHNOLOGIES,	5997	Z3052 HS CART 3	10.94
30140	9101	03/18/19	MT BUSINESS TECHNOLOGIES,	5997	Z3053 HS CART 1	7.39
30140	9101	03/18/19	MT BUSINESS TECHNOLOGIES,	5997	Z3054 HS CART 4	5.82
30140	9101	03/18/19	MT BUSINESS TECHNOLOGIES,	5997	Z3158 EL OFFICE	6.80
30140	9101	03/18/19	MT BUSINESS TECHNOLOGIES,	5997	Z3161 EL LAB 511	6.85
TOTAL CHECK						993.29
30141	9101	03/18/19	MUNETRIX	7410	RENEWAL 18.19	4,419.00
30142	9101	03/18/19	OFFICE DEPOT,INC	5990	1388656 DURACELL PROCELL	7.83
30142	9101	03/18/19	OFFICE DEPOT,INC	5990	741985 DURACELL PROCELL A	4.20
30142	9101	03/18/19	OFFICE DEPOT,INC	5910	741985 DURACELL PROCELL A	4.20
30142	9101	03/18/19	OFFICE DEPOT,INC	5990	981406 DURACELL PROCELL P	4.31
30142	9101	03/18/19	OFFICE DEPOT,INC	5990	ESTIMATED SHIPPING/HANDLI	2.00
30142	9101	03/18/19	OFFICE DEPOT,INC	5990	ESTIMATED SHIPPING/HANDLI	2.00
30142	9101	03/18/19	OFFICE DEPOT,INC	5910	ESTIMATED SHIPPING/HANDLI	2.00
TOTAL CHECK						26.54
30143	9101	03/18/19	PEARSON EDUCATION	5210	ESTIMATED SHIPPING/HANDLI	82.06
30143	9101	03/18/19	PEARSON EDUCATION	5210	ISBN: 9780134433691 CAMPB	1,172.29
TOTAL CHECK						1,254.35
30144	9101	03/18/19	PERRY PRO TECH	4220	I1825 I1826 MS COPIER	299.46
30144	9101	03/18/19	PERRY PRO TECH	4220	I1825 I1826 MS COPIER	6.11
TOTAL CHECK						305.57

SPI  
 DATE: 03/14/2019  
 TIME: 13:57:36

MADISON SCHOOL DISTRICT  
 CHECK REGISTER

PAGE NUMBER: 4  
 VENCHK11  
 ACCOUNTING PERIOD: 9/19

FUND - 11 - GENERAL FUND

CHECK NUMBER	CASH ACCT	DATE ISSUED	VENDOR	ACCT	DESCRIPTION	AMOUNT
30145	9101	03/18/19	72652	PETTY CASH	5910	POSTAGE 7.85
30145	9101	03/18/19	72652	PETTY CASH	5910	POSTAGE 26.10
TOTAL CHECK						33.95
30146	9101	03/18/19	74940	QUILL CORPORATION	5910	ITEM # 901-720559 MODEL 5.61
30146	9101	03/18/19	74940	QUILL CORPORATION	5910	ITEM # 901-720561 MODEL 5.61
30146	9101	03/18/19	74940	QUILL CORPORATION	5910	ITEM # 901-720563 MODEL 5.61
30146	9101	03/18/19	74940	QUILL CORPORATION	5910	ITEM # 901-720567 MODEL 5.61
30146	9101	03/18/19	74940	QUILL CORPORATION	5990	PC1300 REMC ITEM# 190040 18.87
TOTAL CHECK						41.31
30147	9101	03/18/19	78064	SAFETY SYSTEMS INC	4220	QUARTERLY LEASE 534.00
30148	9101	03/18/19	81702	SECRET WARDLE	3170	ADAIR VS STATE 29.47
30149	9101	03/18/19	82982	SILVERBACK SUPPLY	5990	TOILET TISSUE 662.50
30150	9101	03/18/19	85485	STAFFORD BUILDING PRODUCT	5980	CLASSROOM LOCK/HINGE 369.00
30150	9101	03/18/19	85485	STAFFORD BUILDING PRODUCT	5980	HINGE -106.00
TOTAL CHECK						263.00
30151	9101	03/18/19	90470	TRANSPORTATION ACCESSORIE	5730	WIPER SWITCH, RED LEN 215.28
30152	9101	03/18/19	91835	UNITED STATES POSTAL SERV	5910	10 ROLLS FOREVER 550.00
30152	9101	03/18/19	91835	UNITED STATES POSTAL SERV	5910	2 ROLLS FOREVER 110.00
30152	9101	03/18/19	91835	UNITED STATES POSTAL SERV	5910	2 ROLLS POSTCARD 70.00
30152	9101	03/18/19	91835	UNITED STATES POSTAL SERV	5910	3 ROLLS FOREVER 165.00
30152	9101	03/18/19	91835	UNITED STATES POSTAL SERV	5910	5 ROLLS FOREVER 275.00
TOTAL CHECK						1,170.00
30153	9101	03/18/19	93316	WARDS NATURAL SCIENCE	5110	AP INVESTIGATION 4: OSMOS 131.96
30153	9101	03/18/19	93316	WARDS NATURAL SCIENCE	5110	DAPHNIA MAGNA, LG, FOR 12 58.60
30153	9101	03/18/19	93316	WARDS NATURAL SCIENCE	5110	FREIGHT PO 190292 JAC 13.52
TOTAL CHECK						204.08
TOTAL FUND						38,259.48
TOTAL REPORT						38,259.48

SPI  
 DATE: 03/14/2019  
 TIME: 13:47:16

MADISON SCHOOL DISTRICT  
 CHECK REGISTER

PAGE NUMBER: 1  
 VENCHK11  
 ACCOUNTING PERIOD: 9/19

FUND - 21 - ATHLETIC

CHECK NUMBER	CASH ACCT	DATE ISSUED	-----VENDOR-----	ACCT	-----DESCRIPTION-----	AMOUNT
10025	9102	03/18/19	10460 BARRETT'S	5990	BALLOONS FOR SR NT	32.00
10026	9102	03/18/19	27783 DOMINO'S PIZZA	5990	ORDER 457586	66.00
10026	9102	03/18/19	27783 DOMINO'S PIZZA	5990	TIP FOR ORDER 457586	10.00
10026	9102	03/18/19	27783 DOMINO'S PIZZA	5990	ORDER 457949	59.00
10026	9102	03/18/19	27783 DOMINO'S PIZZA	5990	TIP FOR ORDER 457949	8.00
TOTAL CHECK						143.00
10027	9102	03/18/19	47396 IMPREST FUND	5990	CHEER FINALS TICKETS	600.00
10028	9102	03/18/19	42250 INSIGNIA GRAPHICS, INC.	5990	MS TRACK SIGNS	135.00
10029	9102	03/18/19	60365 THE NATIONAL FOOTBALL FOU	7410	TAZ WALLACE RENEWAL	99.00
TOTAL FUND						1,009.00
TOTAL REPORT						1,009.00

## **Superintendent's Report March 18, 2019**

### **1. MASB Elections (Information Item)**

The following members were recently selected for seats on the MASB Board of Directors for three-year terms unless otherwise noted.

New Directors:

- Region 3—John Siemion, Grand Haven Area Public Schools (54% of vote)
- Region 6—Donald Myers, Harper Creek Community Schools, two-year term (61% of vote)
- Region 8—Darlene Pomponio, Ph.D., Southgate Community Schools (24% of vote)
- Group VII—Deborah Hunter-Harvill, Detroit Public Schools Community District (appointed)
- Member At-Large—Susan Baskett, Ann Arbor Public Schools (appointed)

Incumbent Directors Reelected to the Board:

- Region 7—Guillermo Lopez, Lansing School District (61% of vote)
- Group V—Steve Hyer, Clarkston Community Schools (68% of vote)

Incumbent Directors Reelected Unopposed:

- Region 4—Ruth Coppens, Saginaw ISD
- Group VI—Shawna Walker, Wayne-Westland Community Schools

### **2. Winter Athletics (Action Item)**

Kris's Athletic Director Board Report is included in your packet, however, I want to extend my congratulations to the teams and individuals who attained, and at this time continue to attain, extraordinary accomplishments this winter athletic season. I recommend the Board adopt a resolution acknowledging the accomplishments of teams and individuals who represented Madison in remarkable fashion throughout this most recent winter athletic season.

### **3. LISD Budget Review (Information Item)**

Board members are invited to the LISD Budget Review Meeting Thursday, April 18<sup>th</sup>. This is to be held at the LISD TECH Center starting at 6:00 p.m. All Madison board members are welcome to join me for the upcoming review. Please let me know if you wish to attend and I will RSVP those interested in attending. Dinner will be served.

#### **4. Cords Across America (Action Item)**

Cord Across America was founded to provide red, white, and blue honor cords to graduates entering the military. The cords are provided at no cost for schools that want to publicly recognize these respective graduates. Amy Horford of Blissfield started Cords Across America, beginning with her daughter who entered the Army following graduation in 2015. If approved each Madison graduate planning to enter the military will receive a cord along with a hand written note recognizing the individual's selfless sacrifice for our country. School districts including Adrian, Sand Creek, Blissfield, Tecumseh, Whiteford, Summerfield, Britton-Deerfield, and Adrian College currently participate with Cords Across America to recognize graduates entering any military branch, National Guard, ROTC, or a military academy. Kristin and I recommend the board approve participation with Cords Across America, recognizing Madison High School graduates who willingly volunteer to serve our country.

#### **5. Amendment – Health Plan A and Health Plan B Purchasing Consortium Agreements (Action Item)**

The Consortium Governing Board held a meeting December 13, 2018 at which the Board unanimously voted to amend four sections within the agreements. The sections include 5.3, 6.8, 7.4, and 9.1. I have placed copies of the Amendment to the Health Plan A Purchasing Consortium Agreement and Amendment to the Health Plan B Purchasing Consortium Agreement in your board packet.

Jennifer was present at the Consortium Governing Board meeting as members recently met to discuss the amendments and aspects of the Hillsdale ISD and its constituent districts joining the Health Care Consortium.

Jennifer and I recommend the board approve the Amendment to the Health Plan A Purchasing Consortium Agreement and Amendment to the Health Plan B Purchasing Consortium Agreement as presented.

**AMENDMENT TO THE HEALTH PLAN A PURCHASING CONSORTIUM AGREEMENT**

This Amendment to the Health Plan A Purchasing Consortium Agreement (hereinafter, the "Amendment") made this 13<sup>th</sup> day of March, 2019, by and between the **Lenawee Intermediate School District** (hereinafter, "LISD") and **Madison School District**, (each individually a "member" and collectively the "Consortium").

**WHEREAS**, on or about the 17 day of September, 2012, the Consortium was established by the LISD and its constituent districts to create a mechanism for collectively purchasing insured medical benefits and coverage as well as health care plan services and related administrative services in order to achieve efficiencies and cost reductions in health care expenditures; and

**WHEREAS**, Section six of the Health Plan A Purchasing Consortium Agreement (hereinafter, the "Agreement") set forth the responsibilities of the fiscal agent and identified the ISD as the fiscal agent (Section 6.8 of the Agreement); and

**WHEREAS**, Section 9.1 of the Agreement stipulates that in order to become a member of the Consortium, the entity must be a general powers school district, intermediate school district, or public school academy located with the geographical boundaries of ISD; and

**WHEREAS**, at a meeting of the Consortium Governing Board held on September 21, 2018, at which 11 of the 12 members of the Consortium were present and represented, the Consortium Governing Board unanimously voted to allow the Hillsdale County Intermediate School District and its constituent school districts to join the Consortium effective January 1, 2019; and

**WHEREAS**, Section 12 of the Agreement stipulates that an amendment to the Agreement is only effective upon the execution of the amendment approved by at least 2/3<sup>rd</sup> of the Consortium Governing Board; and

**WHEREAS**, at a meeting of the Consortium Governing Board held on December 13, 2018, at which 8 of the 12 members of the Consortium (2/3<sup>rd</sup> of the membership) were present and represented, the Consortium Governing Board unanimously voted to amend the Agreement as is set forth in this Amendment; and

**WHEREAS**, the consideration contained in the Agreement forms the basis for this Amendment; and

**WHEREAS**, except as amended by this Amendment, the remaining terms and conditions of the Agreement and any earlier amendments will remain in full force and effect.

**NOW, THEREFORE**, in consideration of the mutual promises and benefits contained in the Agreement, the members of the Consortium agree as follows:

1. Section 5.3 of the Agreement is hereby amended as follows:

5.3 The Governing Board shall be responsible for selected a Steering Committee consisting of five (5) members of the Governing Board that represent the LISD or a constituent district of the LISD and two (2) members of the Governing Board that represent the Hillsdale County Intermediate School District or a constituent district of the Hillsdale County Intermediate School District. In addition, the Superintendent (or designee) of the Fiscal Agent district shall serve as a member of the Steering Committee. The Steering Committee shall be responsible for carrying out the operational aspects of the Consortium, to the extent that such matters have been delegated to the Steering Committee by the Governing Board.

2. Section 6.8 of the Agreement is hereby amended as follows:

6.8 The LISD shall serve as the Fiscal Agent to the Consortium until such time as it voluntarily relinquishes that position in writing or at such time that the Governing Board votes by 2/3 majority to replace the LISD as Fiscal Agent.

3. Section 7.4 of the Agreement is hereby amended as follows:

7.4 The Fiscal Agent shall receive administrative fees for its services. The amount of administrative fees payable by each member of the Consortium shall be determined by a formula to be determined by the Consortium Governing Board that is acceptable to the Fiscal Agent attributable to the Service(s) in which the member participates. The administrative fees shall be assessed and paid monthly to the Fiscal Agent by each member of the Consortium. The Governing Board shall annually (by June 30) review the administrative fee and may modify that fee by two-thirds (2/3) majority vote.

4. Section 9.1 of the Agreement is hereby amended as follows:

9.1 In order to be eligible to become a member of the Consortium, the entity must be a general powers school district, intermediate school district, or public school academy located within the geographical boundaries of the state of Michigan.

New members may join the Consortium upon a 2/3 majority vote of the Governing Board and the express obligation to be bound by the terms of this Agreement, as may be modified from time to time. Existing members may withdraw from the Consortium in accordance with Section 9.2 below. A withdrawing member forfeits any right to a distribution of Consortium assets or funds upon termination and dissolution, which right shall revert to the remaining and non-withdrawing members.

If a new member is admitted to the Consortium, under the procedures specified above, the expiration of its initial commitment to membership

shall coincide with the expiration of the membership interval for other members of the Consortium as is specified in Section 9.2.

5. Miscellaneous.

- (a) Except as specifically modified by this Amendment, the Agreement and all earlier amendments will continue in full force and effect and are hereby ratified and confirmed by this Amendment.
- (b) This Amendment shall be construed, interpreted and enforced under the laws of the State of Michigan.
- (c) This Amendment is binding upon and shall inure to the benefit of the Parties and their respective permitted successors and assigns.
- (d) In the event of any conflict between the terms of this Amendment and the terms of the Agreement, the terms of this Amendment shall govern and control.
- (e) This Amendment may be executed in separate counterparts, including facsimile copies, each of which shall be deemed an original, all of which counterparts shall constitute one in the same Amendment.

**Member District**

**Lenawee Intermediate School District**

By: \_\_\_\_\_

By: \_\_\_\_\_

Mark E. Haag, Ed.S.

Name: \_\_\_\_\_

Its: \_\_\_\_\_

Its: Superintendent

Date: \_\_\_\_\_

Date: \_\_\_\_\_



**AMENDMENT TO THE HEALTH PLAN B PURCHASING CONSORTIUM AGREEMENT**

This Amendment to the Health Plan B Purchasing Consortium Agreement (hereinafter, the "Amendment") made this 13<sup>th</sup> day of March, 2019, by and between the **Lenawee Intermediate School District** (hereinafter, "LISD") and **Madison School District**, (each individually a "member" and collectively the "Consortium").

**WHEREAS**, on or about the 17 day of September, 2012, the Consortium was established by the LISD and its constituent districts to create a mechanism for collectively purchasing insured medical benefits and coverage as well as health care plan services and related administrative services in order to achieve efficiencies and cost reductions in health care expenditures; and

**WHEREAS**, Section six of the Health Plan B Purchasing Consortium Agreement (hereinafter, the "Agreement") set forth the responsibilities of the fiscal agent and identified the ISD as the fiscal agent (Section 6.8 of the Agreement); and

**WHEREAS**, Section 9.1 of the Agreement stipulates that in order to become a member of the Consortium, the entity must be a general powers school district, intermediate school district, or public school academy located with the geographical boundaries of ISD; and

**WHEREAS**, at a meeting of the Consortium Governing Board held on September 21, 2018, at which 11 of the 12 members of the Consortium were present and represented, the Consortium Governing Board unanimously voted to allow the Hillsdale County Intermediate School District and its constituent school districts to join the Consortium effective January 1, 2019; and

**WHEREAS**, Section 12 of the Agreement stipulates that an amendment to the Agreement is only effective upon the execution of the amendment approved by at least 2/3<sup>rd</sup> of the Consortium Governing Board; and

**WHEREAS**, at a meeting of the Consortium Governing Board held on December 13, 2018, at which 8 of the 12 members of the Consortium (2/3<sup>rd</sup> of the membership) were present and represented, the Consortium Governing Board unanimously voted to amend the Agreement as is set forth in this Amendment; and

**WHEREAS**, the consideration contained in the Agreement forms the basis for this Amendment; and

**WHEREAS**, except as amended by this Amendment, the remaining terms and conditions of the Agreement and any earlier amendments will remain in full force and effect.

**NOW, THEREFORE**, in consideration of the mutual promises and benefits contained in the Agreement, the members of the Consortium agree as follows:

1. Section 5.3 of the Agreement is hereby amended as follows:

- 5.3 The Governing Board shall be responsible for selected a Steering Committee consisting of five (5) members of the Governing Board that represent the LISD or a constituent district of the LISD and two (2) members of the Governing Board that represent the Hillsdale County Intermediate School District or a constituent district of the Hillsdale County Intermediate School District. In addition, the Superintendent (or designee) of the Fiscal Agent district shall serve as a member of the Steering Committee. The Steering Committee shall be responsible for carrying out the operational aspects of the Consortium, to the extent that such matters have been delegated to the Steering Committee by the Governing Board.
2. Section 6.8 of the Agreement is hereby amended as follows:
- 6.8 The LISD shall serve as the Fiscal Agent to the Consortium until such time as it voluntarily relinquishes that position in writing or at such time that the Governing Board votes by 2/3 majority to replace the LISD as Fiscal Agent.
3. Section 7.4 of the Agreement is hereby amended as follows:
- 7.4 The Fiscal Agent shall receive administrative fees for its services. The amount of administrative fees payable by each member of the Consortium shall be determined by a formula to be determined by the Consortium Governing Board that is acceptable to the Fiscal Agent attributable to the Service(s) in which the member participates. The administrative fees shall be assessed and paid monthly to the Fiscal Agent by each member of the Consortium. The Governing Board shall annually (by June 30) review the administrative fee and may modify that fee by two-thirds (2/3) majority vote.
4. Section 9.1 of the Agreement is hereby amended as follows:
- 9.1 In order to be eligible to become a member of the Consortium, the entity must be a general powers school district, intermediate school district, or public school academy located within the geographical boundaries of the state of Michigan.

New members may join the Consortium upon a 2/3 majority vote of the Governing Board and the express obligation to be bound by the terms of this Agreement, as may be modified from time to time. Existing members may withdraw from the Consortium in accordance with Section 9.2 below. A withdrawing member forfeits any right to a distribution of Consortium assets or funds upon termination and dissolution, which right shall revert to the remaining and non-withdrawing members.

If a new member is admitted to the Consortium, under the procedures specified above, the expiration of its initial commitment to membership

shall coincide with the expiration of the membership interval for other members of the Consortium as is specified in Section 9.2.

5. Miscellaneous.

- (a) Except as specifically modified by this Amendment, the Agreement and all earlier amendments will continue in full force and effect and are hereby ratified and confirmed by this Amendment.
- (b) This Amendment shall be construed, interpreted and enforced under the laws of the State of Michigan.
- (c) This Amendment is binding upon and shall inure to the benefit of the Parties and their respective permitted successors and assigns.
- (d) In the event of any conflict between the terms of this Amendment and the terms of the Agreement, the terms of this Amendment shall govern and control.
- (e) This Amendment may be executed in separate counterparts, including facsimile copies, each of which shall be deemed an original, all of which counterparts shall constitute one in the same Amendment.

**Member District**

**Lenawee Intermediate School District**

By: \_\_\_\_\_

By: \_\_\_\_\_

Mark E. Haag, Ed.S.

Name: \_\_\_\_\_

Its: \_\_\_\_\_

Its: Superintendent

Date: \_\_\_\_\_

Date: \_\_\_\_\_

## Board Report

Kristin Thomas, Principal

Madison High School

March 18<sup>th</sup>, 2019

- I. Testing – The Assessment Season is upon us! Our 11<sup>th</sup> grade students will take the SAT on Tuesday, April 9<sup>th</sup>, the ACT WorkKeys on Wednesday, April 10<sup>th</sup>, and the M-Step for Science and Social Studies the following week. Our sophomores will take the PSAT 10 on Thursday, April 11<sup>th</sup> and our freshmen will take the PSAT 8/9 on Wednesday, April 10<sup>th</sup>. In addition to these assessments, we will also be NWEA testing in later April/Early May. Our seniors will also retake the COMPASS college placement test in May. AP Exams will be administered during the 2<sup>nd</sup> & 3<sup>rd</sup> weeks of May.
  
- II. Hudson Tech Alternative Program – Throughout the course of this school year we have had a group of students who have struggled to achieve academic success. We provided these students with every resource we had available, but for a variety of reasons, we were not able to move the dial with these students. In an effort to find an environment where they might be more successful, Dr. Rowe and I met with administrators in Hudson and have agreed to work together to provide 10 students the opportunity to attend the Hudson Tech Alternative Program for the 3<sup>rd</sup> trimester. These students are currently still enrolled as Madison High School students, but are attending full time at the Hudson Tech Alternative Program housed at the Center for Science and Industry. Hudson is sending a bus here to Madison to pick these students up and we are picking them up at the end of the day and providing transportation home. These students spend part of their day working in online coursework and the rest of their day learning in the Mechatronics classroom. If successful, these students would look to enroll in the Hudson Program next Fall.
  
- III. Celebrations - The Madison High School Family has much to be proud of these days! Congrats to the following:
  - Congrats to our HS Orchestra who competed for the first time as a Varsity Orchestra and earned an overall rating of 2. This is fantastic considering that a majority of our orchestra is comprised of freshmen.
  
  - Congrats to our Varsity Bowling Teams. Our Boys missed advancing to the state tournament by 4 pins, but we had 3 bowlers who advanced as individuals. Those bowlers are Senior Anthony Contreras and Juniors Keegan Newcomb and Isabell Young. All represented Madison very well! Keegan Newcomb finished 17<sup>th</sup> and Anthony placed 32<sup>nd</sup> for the boys and Isabell Young played extremely well down the stretch and placed 3<sup>rd</sup> in the state overall!

- Congrats to Coach Emily Gafford and our Varsity Competitive Cheer Team on a 3<sup>rd</sup> place finish at the MHSAA State Competitive Cheer Meet.
- Congrats to Coach Thompson and our Varsity Boys Basketball Team on a District Championship with an exciting victory over Columbia Central!
- Congrats to our HS Band who competed at the MSBOA Festival and brought home a rating of 1!!! This is quite the accomplishment and we are proud of the strong reputation our HS Band is establishing.
- Congrats to Coach McNeil and our Varsity Girls Basketball Team on a League Championship, a District Championship, and the first Regional Championship in Madison history! Our Lady Trojans will take on a tough Ypsilanti Arbor Prep team tomorrow night at Tecumseh High School.

Brad Anschuetz , Principal  
Madison Middle School  
Board Report  
March 18, 2019

**I. Madison Middle School Art program** has placed a student in either the “Top 100” or “Top 15” for the past four years in a row. I am proud to announce that Teagan Sullivan, 6th grade, (Cat, Mixed Media piece 18”x24”), Michael Fox, 8<sup>th</sup> grade, (Brick-wall & Space piece, Charcoal, Pencil & Acrylic Paint), and Rowen Yeager, 6<sup>th</sup> grade, (Light-bulbs, Watercolor painting) won Top 100 at the state level competition for their art pieces while Annie McDade, 8<sup>th</sup> grade, (Calum Hood, Pencil Drawing) won Top 15! Top 15 is the highest honor at the middle school level.

**II.** There are currently 52 students making payments to attend next year’s **eighth-grade Northern Michigan Tour** from October 3<sup>rd</sup>, 2019 through October 5<sup>th</sup>, 2019. The cost of the trip is \$590 and includes all meals, accommodations, and admittance tickets. Among other opportunities, students will tour the Historic Mill Creek Discovery Park, visit Colonial Michilimackinac, watch a Jack Pine Lumberjack Show, visit Castle Rock, take a Pictured Rocks boat cruise, admire the Tahquamenon Falls, ride a ferry over to Mackinac Island, and visit Fort Makinac.

**III.** The **Madison Middle School (MMS) Concert Band** (7<sup>th</sup> and 8<sup>th</sup>) and the **MMS Orchestra (7<sup>th</sup> and 8<sup>th</sup>)** performed at the annual MSBOA Festival. The MMS Orchestra earned an overall excellent rating (II) with one floor judge recording a superior (I) rating for the orchestra. The MMS Band received an overall rating of good (III) with an excellent rating (II) in site reading.

**V.** Jill Brandeberry, Greg Marten, Janelle Wonders, and I visited several innovative labs within our region as a prelude to developing a vision for **reimagining our computer science lab**. A layout of the proposed vision for the new lab is included for review. The front of the room will be relocated to the west wall. In the event a large space is needed for projects (robotics) all furniture will be on casters in order to move freely about the room. Other features of the new lab include flexible seating with both high top and round tables for collaboration, as well as individualized seating. Students will be able to stand or sit while working at the high top tables.

The southeast corner includes a sound proof room for recording and a collaboration station extending off the south wall. At this station, students will be able to bring their work up onto a viewing screen to discuss and analyze with their peers. Laptops with larger monitors and faster processors will be utilized in the lab. Frosted glass white boards will cover the walls allowing students to brainstorm in teams. Cabinetry that allows for the storage of larger projects will outline the room.

# Project: Madison Adrian Schools

Designer: Claire McNaught 616.813.1970  
Revision: No.2

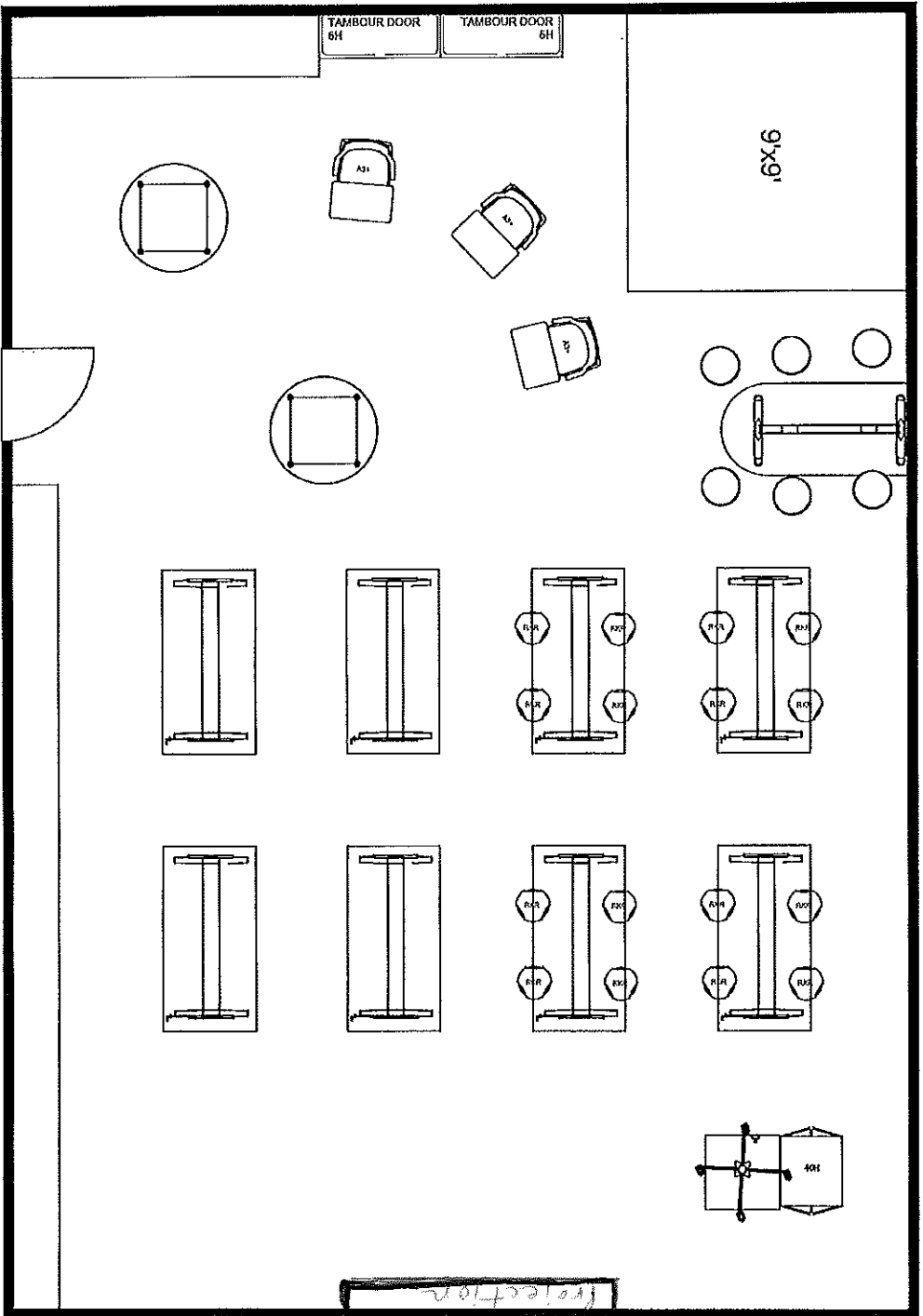

Scale 3/16" = 1'-00"

Science Room

2018/-2019	July &Aug	Sept	Oct	Nov	Dec	Jan	Feb
<b>Revenue</b>							
Breakfast	\$0.00	\$469.60	\$710.60	\$776.40	\$551.50	\$432.30	\$650.60
Lunch & Ala Cart	\$129.95	\$12,143.90	\$9,589.42	\$12,532.15	\$10,921.25	\$7,672.75	\$13,057.55
Juice Machine	\$0.00	\$0.00	\$0.00	\$0.00	\$0.00	\$0.00	\$0.00
State Matching Funds	\$0.00	\$0.00	\$0.00	\$0.00	\$0.00	\$0.00	\$0.00
Interest & Rebates	\$0.00	\$0.00	\$0.00	\$0.00	\$0.00	\$0.00	\$0.00
Lunch & Breakfast Reimb	\$15,370.50	\$71,682.04	\$83,685.63	\$76,256.83	\$60,850.48	\$44,966.94	\$45,559.36
<b>Total</b>	<b>\$15,500.45</b>	<b>\$84,295.54</b>	<b>\$93,985.65</b>	<b>\$89,565.38</b>	<b>\$72,323.23</b>	<b>\$53,071.99</b>	<b>\$59,267.51</b>
<b>Expenses</b>							
Payroll	\$9,427.45	\$11,684.15	\$20,262.40	\$27,405.25	\$20,088.45	\$13,672.62	\$14,100.17
Retirement	\$1,880.11	\$2,309.68	\$4,832.70	\$6,518.16	\$4,790.20	\$3,228.78	\$3,325.26
F.I.C.A.	\$721.20	\$893.84	\$1,550.06	\$2,096.50	\$1,536.77	\$1,045.92	\$1,078.66
Aids	\$4,290.00	\$4,290.00	\$4,290.00	\$4,290.00	\$4,290.00	\$4,290.00	\$4,290.00
Food	\$8,318.78	\$28,810.20	\$45,961.77	\$26,811.44	\$36,284.64	\$34,553.44	\$36,842.70
Uniforms	\$0.00	\$1,355.00	\$0.00	\$0.00	\$0.00	\$0.00	\$0.00
Utilities	\$0.00	\$796.88	\$796.87	\$796.87	\$796.87	\$796.87	\$945.70
Equipment/ Capital outlay	\$0.00	\$0.00	\$0.00	\$0.00	\$0.00	\$1,558.95	\$0.00
Supplies	\$56.80	\$440.20	\$0.00	\$2,665.00	\$3,257.64	\$2,397.27	\$2,419.77
Sales Tax	\$0.00	\$4.91	\$24.96	\$32.69	\$32.69	\$28.96	\$0.00
Repairs	\$0.00	\$0.00	\$0.00	\$0.00	\$0.00	\$1,378.84	\$0.00
Misc./Dues/Fees/Indirect	\$1,374.90	\$65.12	\$264.18	\$121.04	\$399.58	\$2,670.10	\$323.21
Juice	\$0.00	\$0.00	\$0.00	\$0.00	\$0.00	\$0.00	\$0.00
<b>Total</b>	<b>\$26,069.24</b>	<b>\$50,649.98</b>	<b>\$77,982.94</b>	<b>\$70,736.95</b>	<b>\$71,476.84</b>	<b>\$65,621.75</b>	<b>\$63,325.47</b>
<b>Monthly Loss/ Gain</b>	<b>(\$10,568.79)</b>	<b>\$33,645.56</b>	<b>\$16,002.71</b>	<b>\$18,828.43</b>	<b>\$846.39</b>	<b>(\$12,549.76)</b>	<b>(\$4,057.96)</b>
<b>Year To Date</b>	<b>(\$10,568.79)</b>	<b>\$23,076.77</b>	<b>\$39,079.48</b>	<b>\$57,907.91</b>	<b>\$58,754.30</b>	<b>\$46,204.54</b>	<b>\$42,146.58</b>